

# CATALOGO RETROVISORI

## MACCHINE AGRICOLE E MOVIMENTO TERRA 2012



**MCA s.r.l.**

33070 CANEVA (PN) - Via Trieste, 17  
Tel. **0434.799.444** r.a. - Fax **0434.799.260**  
info@mcadicambi.it - [www.mcaricambi.it](http://www.mcaricambi.it)

---

**CONCESSIONARIA DI RICAMBI E ACCESSORI PER AUTOVEICOLI**



# Ministero delle Infrastrutture e dei Trasporti

Dipartimento per i Trasporti, la Navigazione  
ed i Sistemi Informativi e Statistici

**Direzione Generale Territoriale Centro Nord e Sardegna**  
**Centro Superiore Ricerche e Prove Autoveicoli e Dispositivi**  
**ROMA**

**CERTIFICATO N.**  
**CERTIFICATE N.**

**050/2010**

- Visti gli articoli 75, 77, 107, 109 e 114 del decreto legislativo 30 aprile 1992, n.285, e successive modificazioni ed integrazioni;
- Visto il decreto 21 Aprile 2009, pubblicato sulla Gazzetta Ufficiale dell'11 Maggio 2009, n. 107 – serie generale;
- Visto il verbale n. **050/2010** del **3/12/2010** della commissione ispettiva, designata per l'effettuazione del sopralluogo;

- Having regard to the legislative decree 30th April 1992, n. 285 and his following updates and integrations, and in particular Article 75, Article 77, Article 107, Article 109 and Article 114 thereof;
- Having regard to the decree 21th April 2009, published on the Official Journal of 11th May 2009, no. 107 – general series;
- Acting in accordance with the report n. **050/2010** of **3/12/2010** of the committee appointed to carry out the inspection;

il costruttore  
*the manufacturer*

**ARSAUTO s.r.l.**

per l'impianto di produzione sito in  
*for the manufacturing plant located in*

**Corso Mandelli,10 10070 CAFASSE (Torino)**

e per il prodotto  
*and for the product*

**Dispositivi per visione indiretta (specchi retrovisori)**

**E' RITENUTO IDONEO ALLA PRODUZIONE IN SERIE**  
**IS QUALIFIED FOR THE PRODUCTION IN SERIES**

Roma, 3/12 /2010

Il presente certificato è valido due anni  
*This certificate is valid two years.*



IL DIRETTORE/THE DIRECTOR  
Dott. ing. Domenico IACOANGELI



Tutti i dispositivi retrovisori di produzione Arsauto, illustrati nel presente catalogo sono conformi a quanto previsto della direttiva 2003/37/CE relativa all'omologazione dei trattori agricoli o forestali a ruote, ed alla direttiva 2009/59/CE relativa ai retrovisori per trattori agricoli o forestali a ruote, che si applica dal 01/01/2010

All the rear mirror devices produced by ARSAUTO, showed in this catalogue comply the Regulation 2003/37/EC regarding the homologation for the wheeled agricultural or forestry tractors and the Regulation 2009/59/EC regarding the rear mirrors for wheeled agricultural or forestry tractors, that is operative from 01/01/2010.

Tous les dispositifs retroviseur, produit par l' Arsauto illustrée dans le présent catalogue, sont conforme à la directive 2003/37/CE relative à l' omolagotion des tracteurs agricoles au forestiers, et à la directive 2009/59/CE rélatve aux retroviseur des tracteurs agricoles au forestieres , appliqué à partir du 01/01/2010.

Alle die Spiegel herstellt von der Firma ARSAUTO, die in diesem Katalog gezeigt sind, folgen die Richtlinie 2003/37/CE fuer die Homologation von land- oder forstwirtschaftliche Zugmaschinen, und die Richtlinie 2009/59/CE fuer die Rueckspiegel fuer land- oder forstwirtschaftliche Zugmaschinen, die gueltig vom 01/01/2010 ist.

Todos los retrovisores producidos para la Empresa ARSAUTO, que son ilustrados en esto catalogo estan conforme a la directiva 2003/37/CE para la homologacion de los tractores agricolas o forestales y a la directiva 2009/59/CE para los retrovisores para tractores agricolas o forestales, que se aplica desde el 01/01/2010.

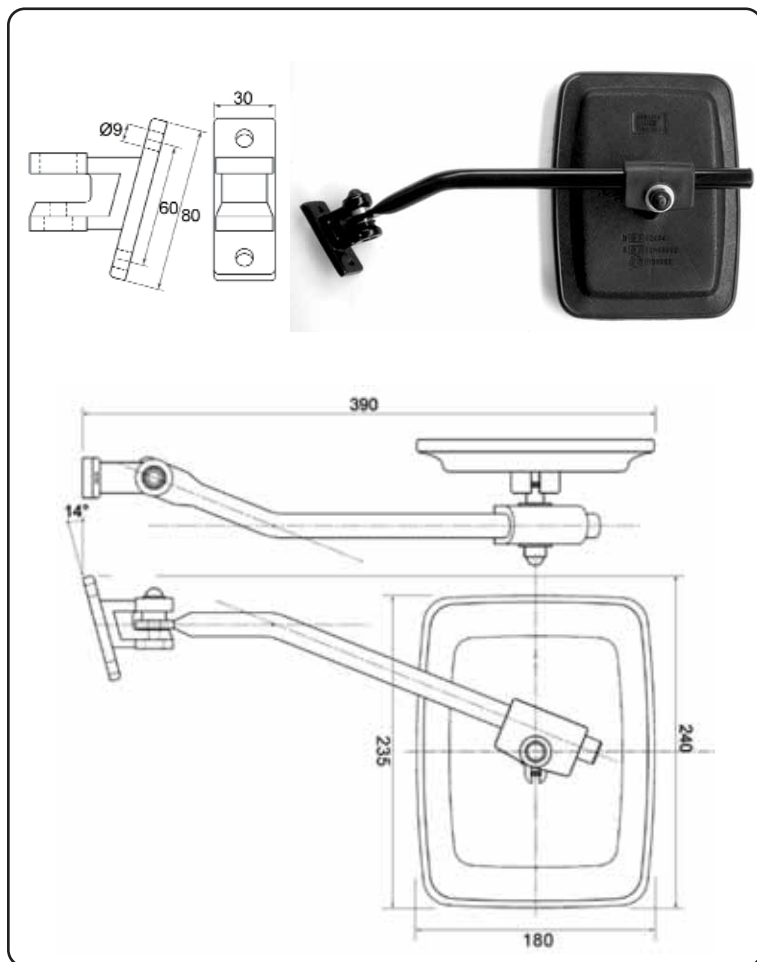

Immagini articoli sinistri / Images of left items

717.ND	▶	☐	●	mm 360 Ø18
717.NS	◀	☐	●	mm 360 Ø18
779.N	◄►	☐	●	mm 235x180

#### APPLICAZIONI / APPLICATIONS

CARRARO AGRITALIA

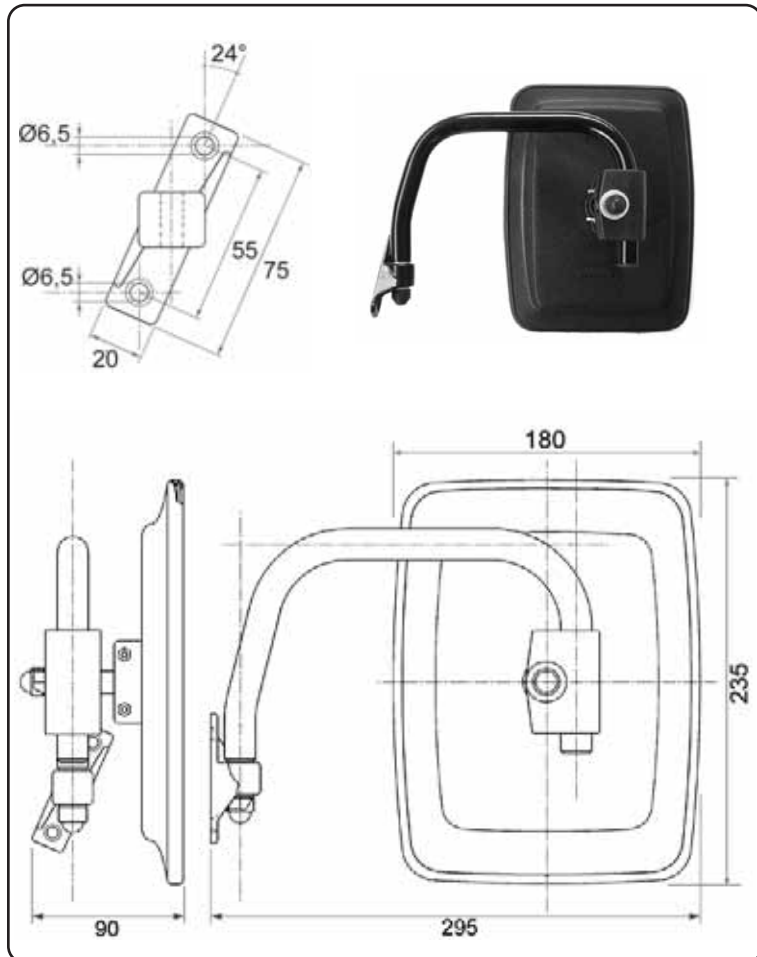

Immagini articoli sinistri / Images of left items

786.ND	▶	☐	●	mm 190 Ø18
786.NS	◀	☐	●	mm 190 Ø18
779.N	◄►	☐	●	mm 235x180

◄►	AMBIDESTRO AMBIDEXTROUS	▶	DESTRO RIGHT	◀	SINISTRO LEFT	☐	COMPLETO COMPLET	☐	COPPA HEAD	☐	BRACCIO ARM	☐	VETRO GLASS	●	NERO BLACK	☐	TERMICO 12V THERMIC 12V
----	----------------------------	---	-----------------	---	------------------	---	---------------------	---	---------------	---	----------------	---	----------------	---	---------------	---	----------------------------

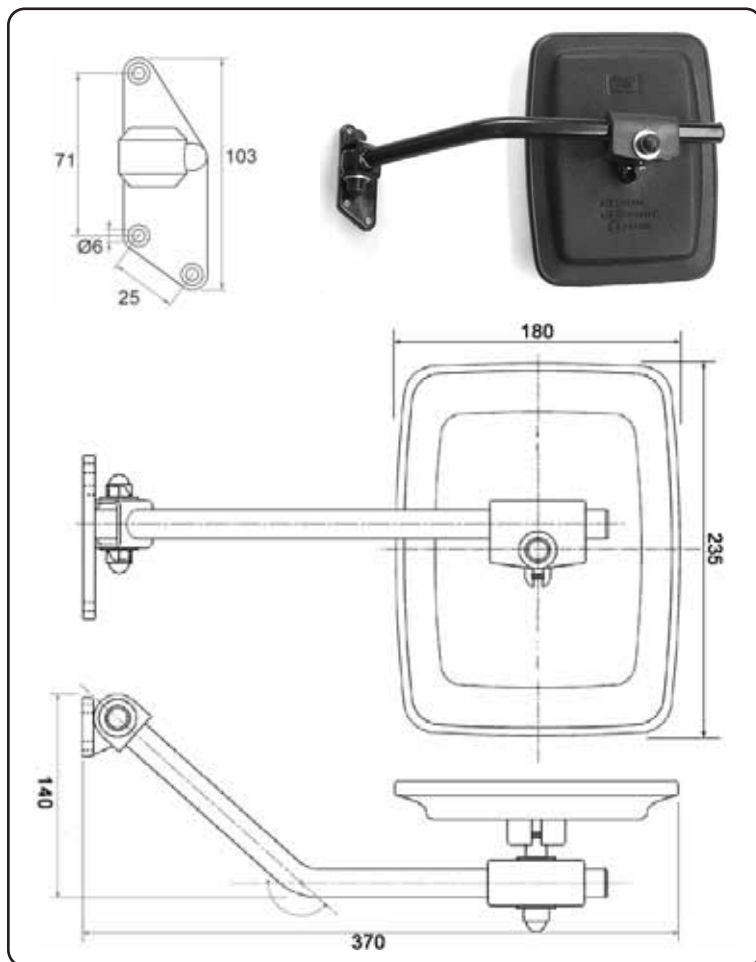

Immagini articoli sinistri / Images of left items

711.NS



mm 300 Ø18

779.N



mm 235x180

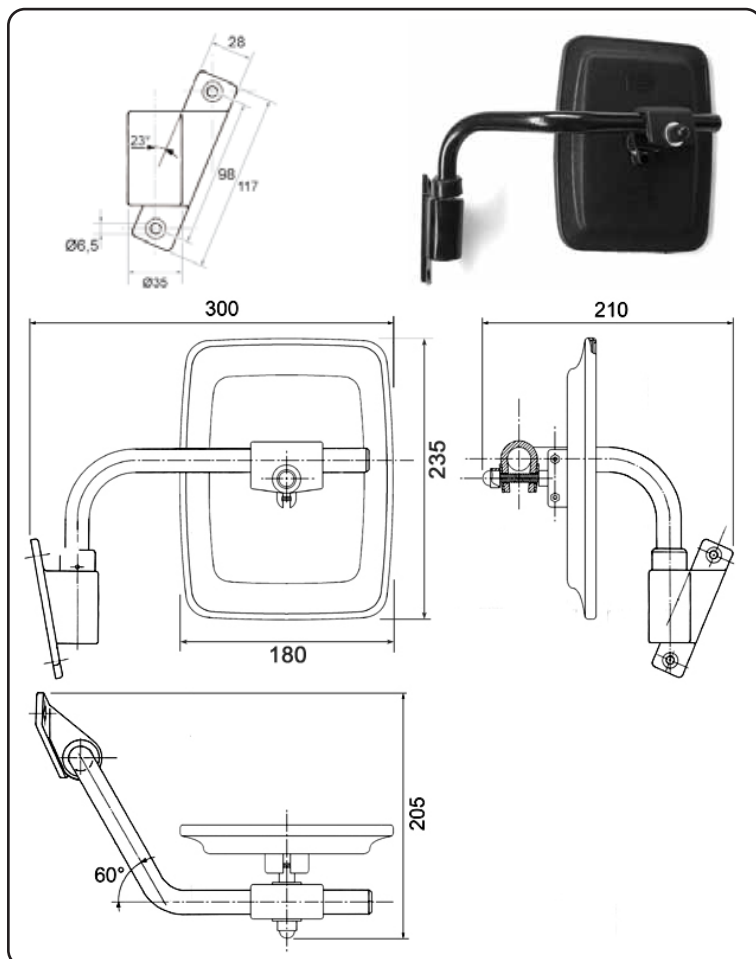

Immagini articoli sinistri / Images of left items

716.ND



mm 300 Ø20

716.NS



mm 300 Ø20

779.N



mm 235x180



AMBIDESTRO  
AMBIDEXTROUS



DESTRO  
RIGHT



SINISTRO  
LEFT



COMPLETO  
COMPLET



COPPA  
HEAD



BRACCIO  
ARM



VETRO  
GLASS



NERO  
BLACK



TERMICO 12V  
THERMIC 12V



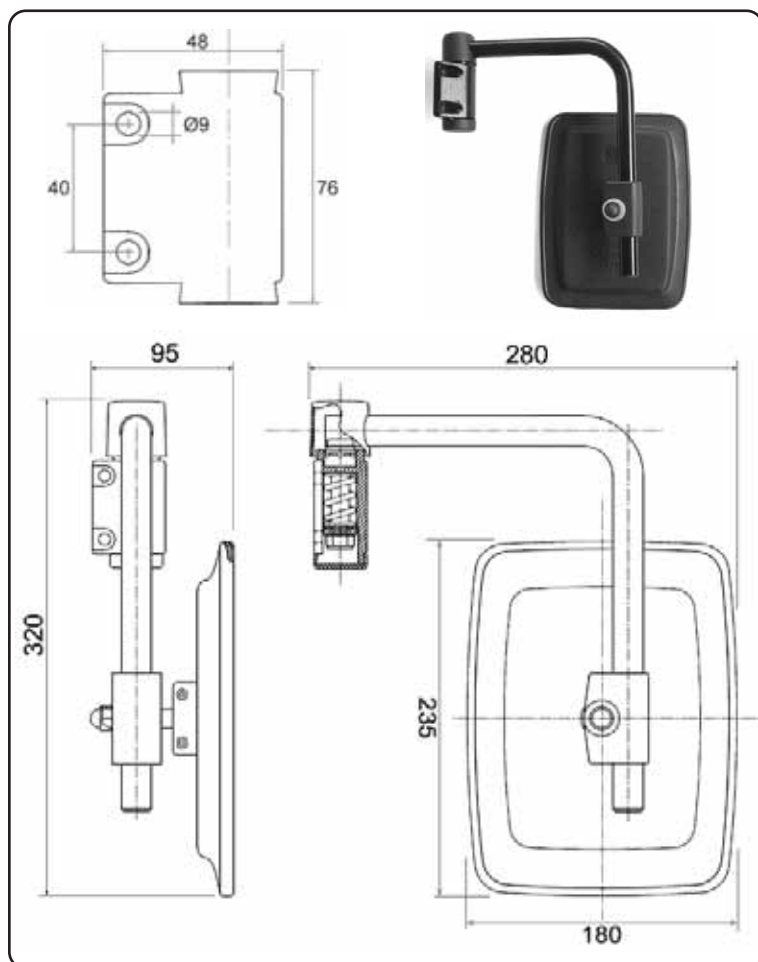

Immagini articoli sinistri / Images of left items

778.ND				mm 197 Ø20
778.NS				mm 197 Ø20
779.N				mm 235x180

#### APPLICAZIONI / APPLICATIONS

SAME-DEUTZ

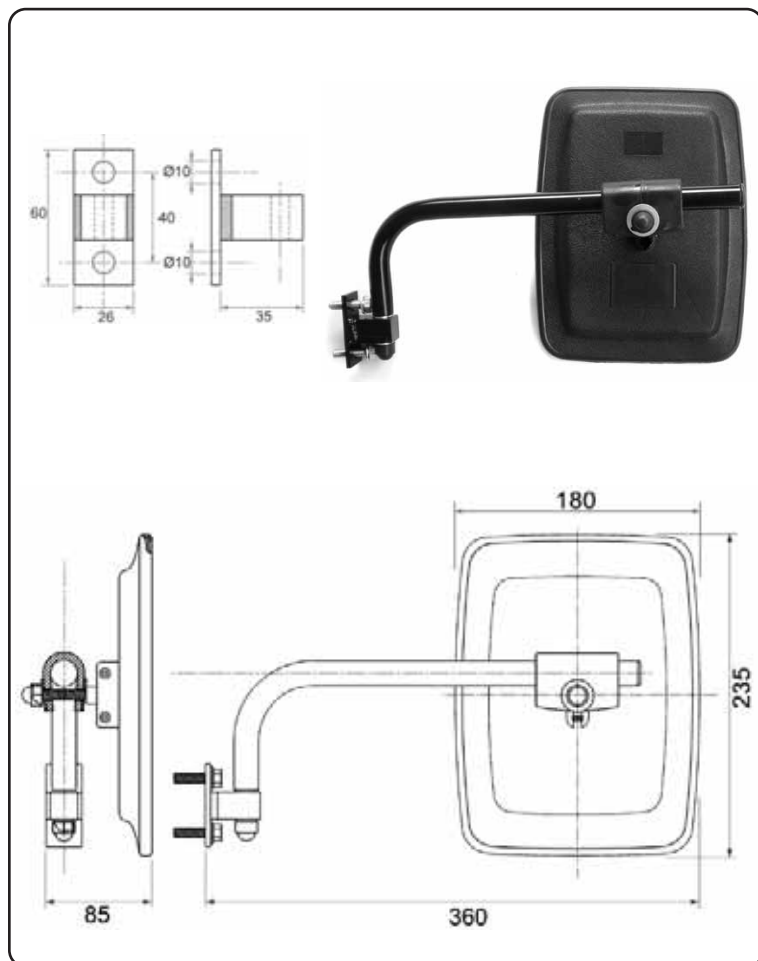

Immagini articoli ambidestri / Images of ambidextrous items

725.N				mm 270 Ø18
779.N				mm 235x180

	AMBIDESTRO AMBIDEXTROUS		DESTRO RIGHT		SINISTRO LEFT		COMPLETO COMPLET		COPPA HEAD		BRACCIO ARM		VETRO GLASS		NERO BLACK		TERMICO 12V THERMIC 12V
--	----------------------------	--	-----------------	--	------------------	--	---------------------	--	---------------	--	----------------	--	----------------	--	---------------	--	----------------------------

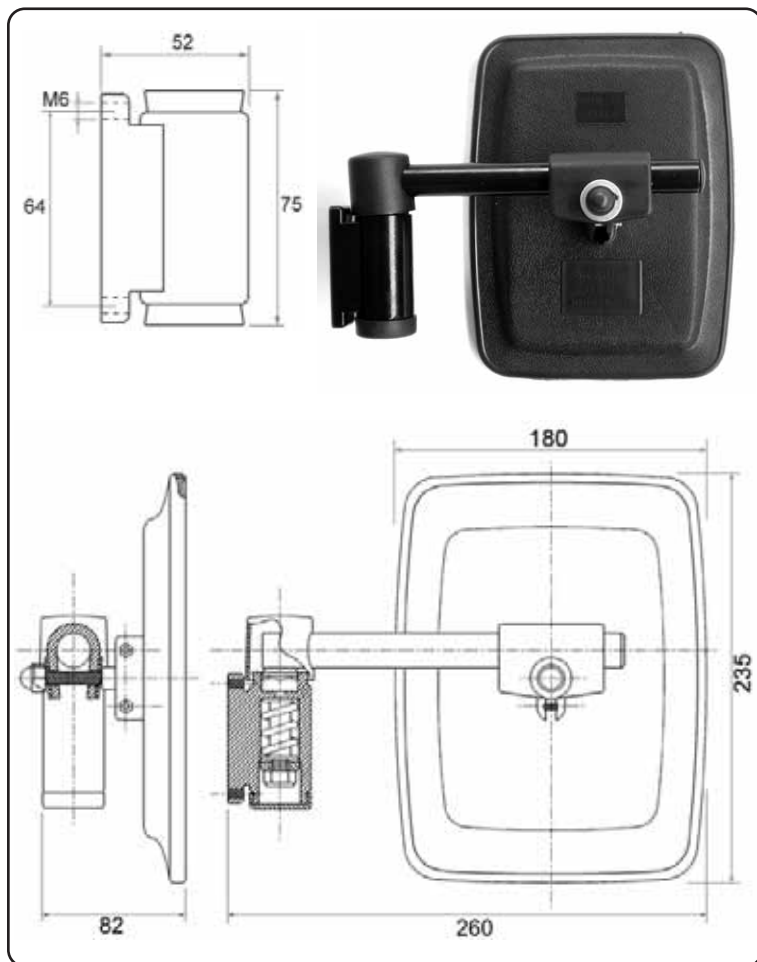

Immagini articoli ambidestri / Images of ambidextrous items

928.N				mm 250 Ø20
779.N				mm 235x180

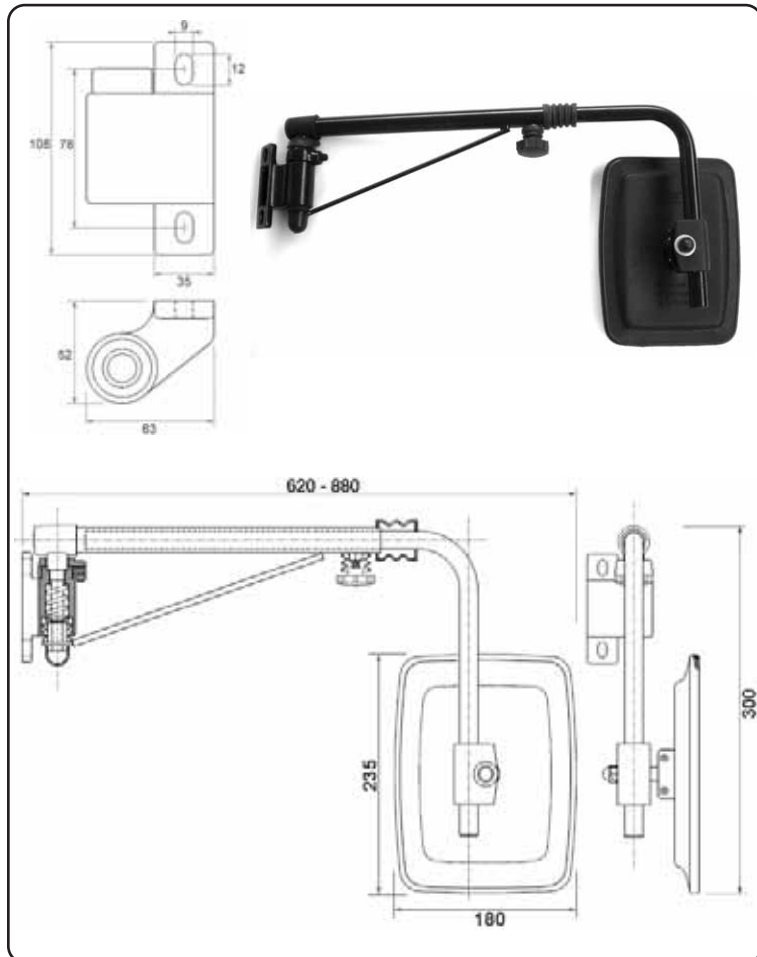

Immagini articoli sinistri / Images of left items

719.ND				mm 450-670 Ø20
719.NS				mm 450-670 Ø20
779.N				mm 235x180

#### APPLICAZIONI / APPLICATIONS

SAME-DEUTZ

	AMBIDESTRO AMBIDEXTROUS		DESTRO RIGHT		SINISTRO LEFT		COMPLETO COMPLET		COPPA HEAD		BRACCIO ARM		VETRO GLASS		NERO BLACK		TERMICO 12V THERMIC 12V
--	----------------------------	--	-----------------	--	------------------	--	---------------------	--	---------------	--	----------------	--	----------------	--	---------------	--	----------------------------

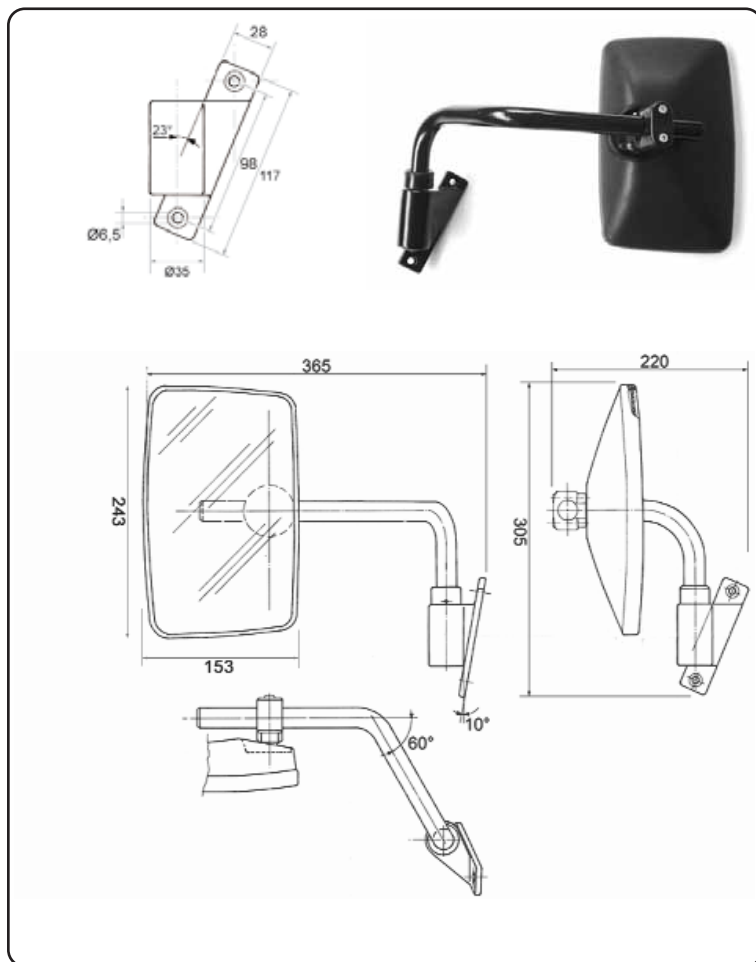

Immagini articoli sinistri / Images of left items

716.ND				mm 300 Ø20
716.NS				mm 300 Ø20
672.N				mm 243x153

#### APPLICAZIONI / APPLICATIONS

BOB CAT  
TIM

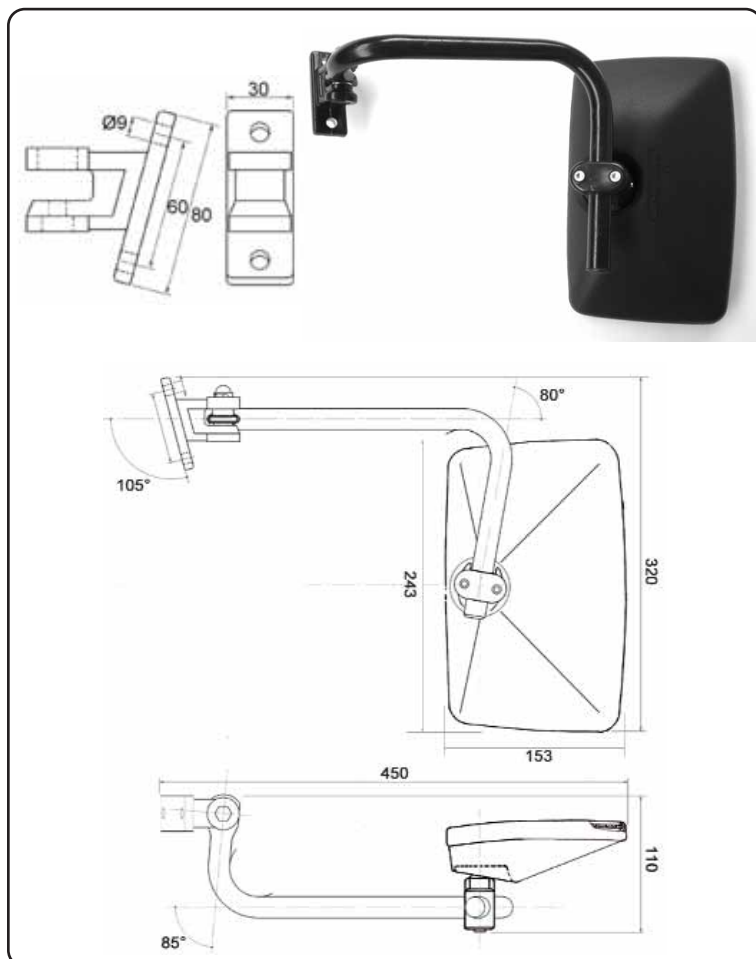

Immagini articoli sinistri / Images of left items

710B.ND				mm 250 Ø18
710B.NS				mm 250 Ø18
672.N				mm 243x153

#### APPLICAZIONI / APPLICATIONS

CESAB

	AMBIDESTRO AMBIDEXTROUS		DESTRO RIGHT		SINISTRO LEFT		COMPLETO COMPLET		COPPA HEAD		BRACCIO ARM		VETRO GLASS		NERO BLACK		TERMICO 12V THERMIC 12V
--	----------------------------	--	-----------------	--	------------------	--	---------------------	--	---------------	--	----------------	--	----------------	--	---------------	--	----------------------------



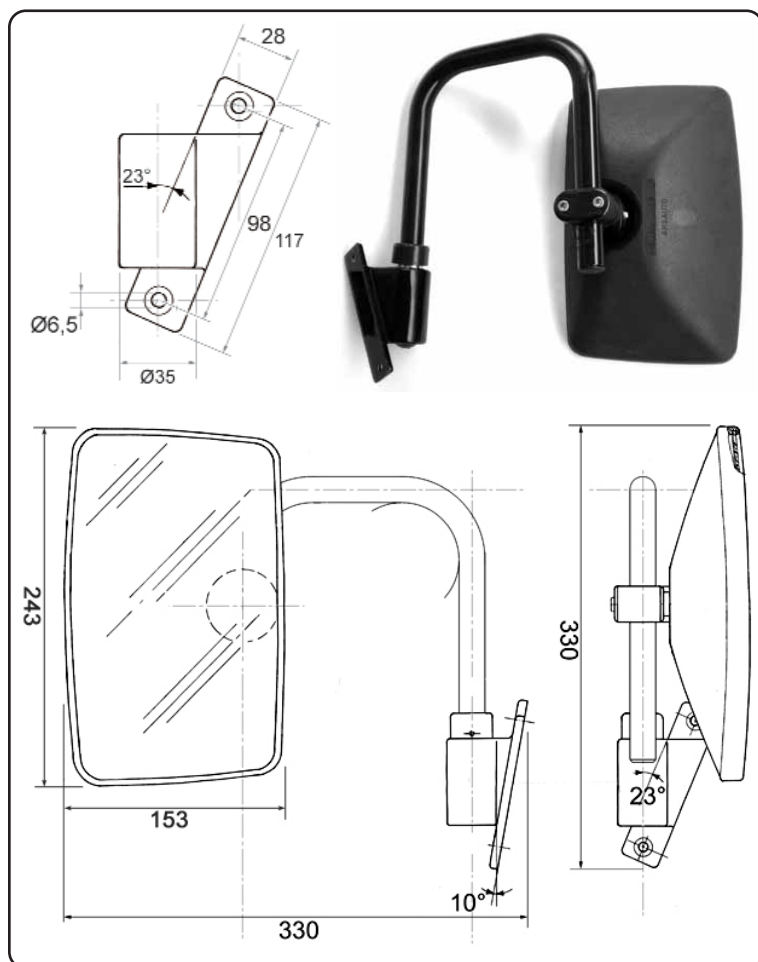

Immagini articoli sinistri / Images of left items

770.NS



mm 160 Ø20

672.N



mm 243x153

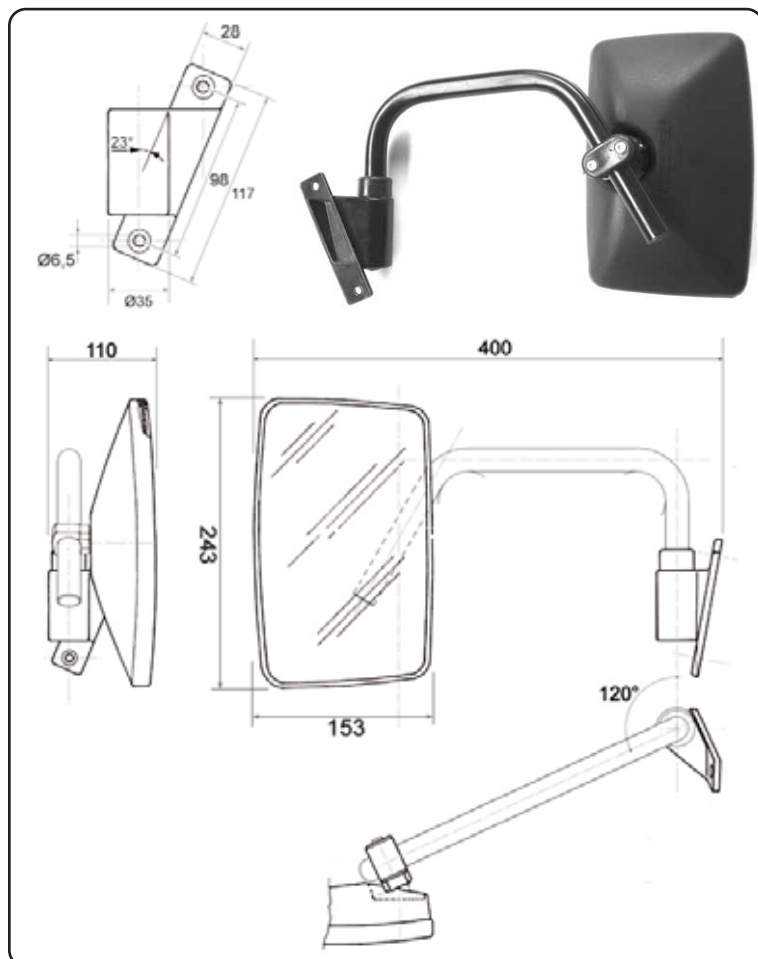

Immagini articoli sinistri / Images of left items

731.ND



mm 260 Ø20

731.NS



mm 260 Ø20

672.N



mm 243x153



AMBIDESTRO  
AMBIDEXTROUS



DESTRO  
RIGHT



SINISTRO  
LEFT



COMPLETO  
COMPLET



COPPA  
HEAD



BRACCIO  
ARM



VETRO  
GLASS



NERO  
BLACK



TERMICO 12V  
THERMIC 12V

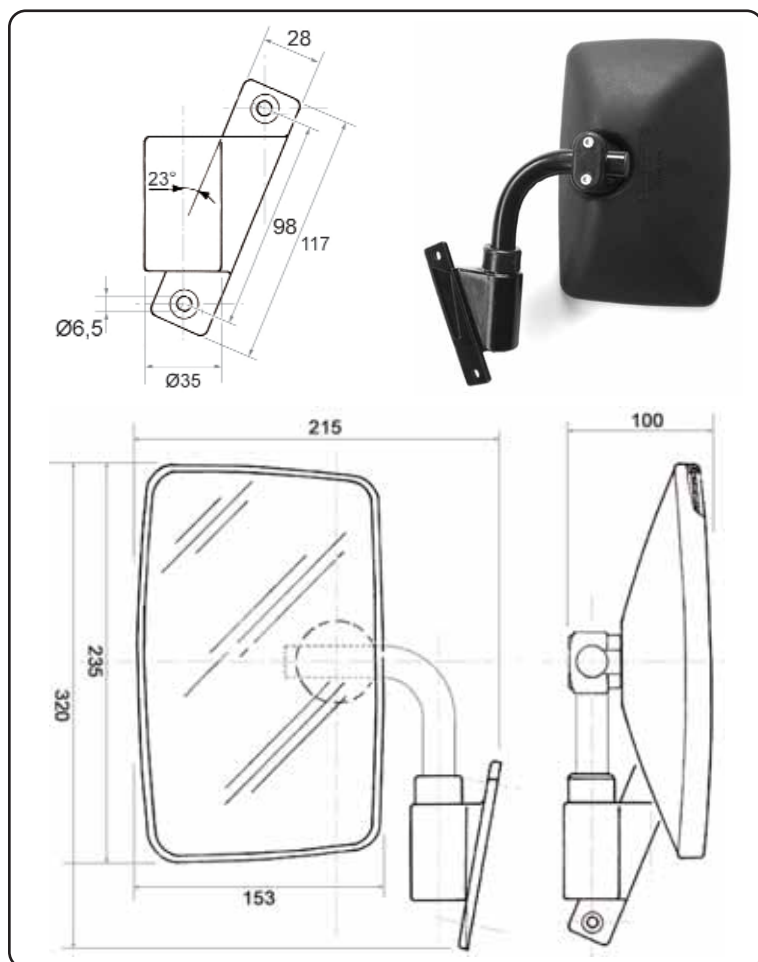

Immagini articoli sinistri / Images of left items

728.ND				mm 120 Ø20
728.NS				mm 120 Ø20
672.N				mm 243x153

#### APPLICAZIONI / APPLICATIONS

NK BIKE

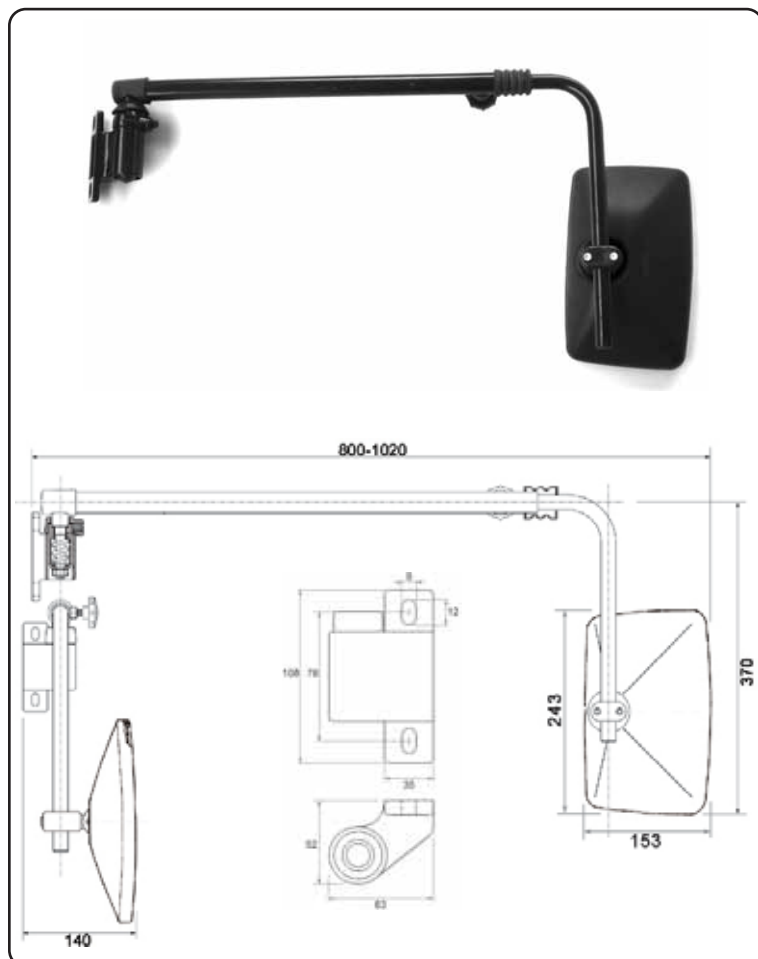

Immagini articoli sinistri / Images of left items

738B.ND				mm 670-890 Ø18
738B.NS				mm 670-890 Ø18
672.N				mm 243x153

#### APPLICAZIONI / APPLICATIONS

CARRARO AGRITALIA

	AMBIDESTRO AMBIDEXTROUS		DESTRO RIGHT		SINISTRO LEFT		COMPLETO COMPLET		COPPA HEAD		BRACCIO ARM		VETRO GLASS		NERO BLACK		TERMICO 12V THERMIC 12V
--	----------------------------	--	-----------------	--	------------------	--	---------------------	--	---------------	--	----------------	--	----------------	--	---------------	--	----------------------------

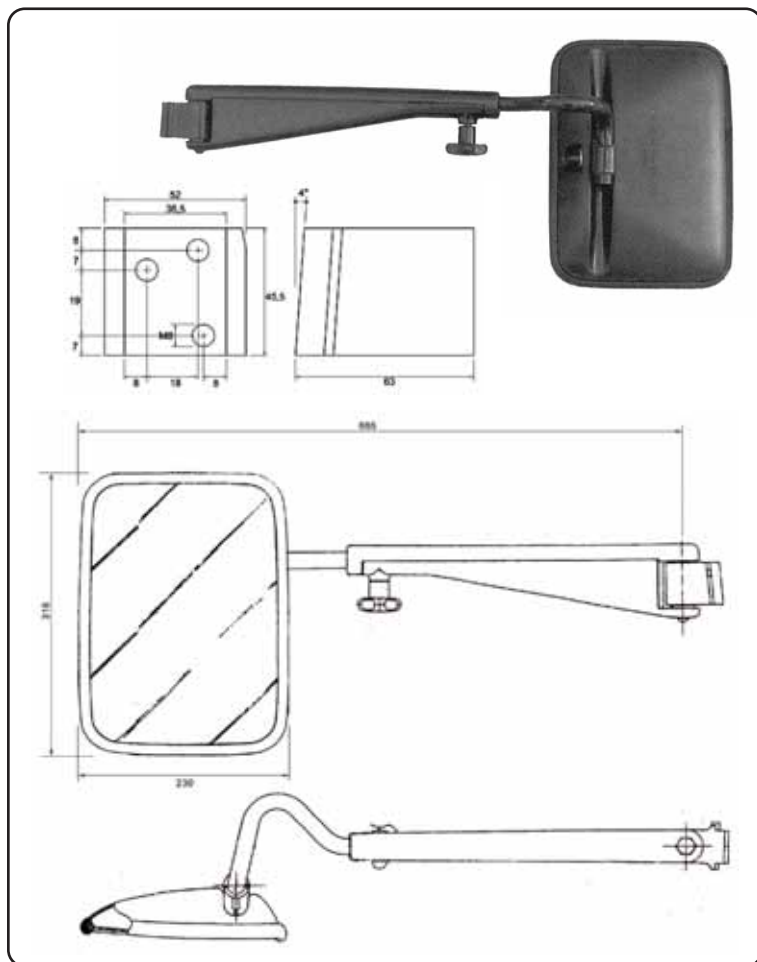

Immagini articoli sinistri / Images of left items

942.ND				mm 530-770 Ø18
942.NS				mm 530-770 Ø18
941.N				mm 318x230
1248.N				mm 302x214

#### APPLICAZIONI / APPLICATIONS

SAME-DEUTZ

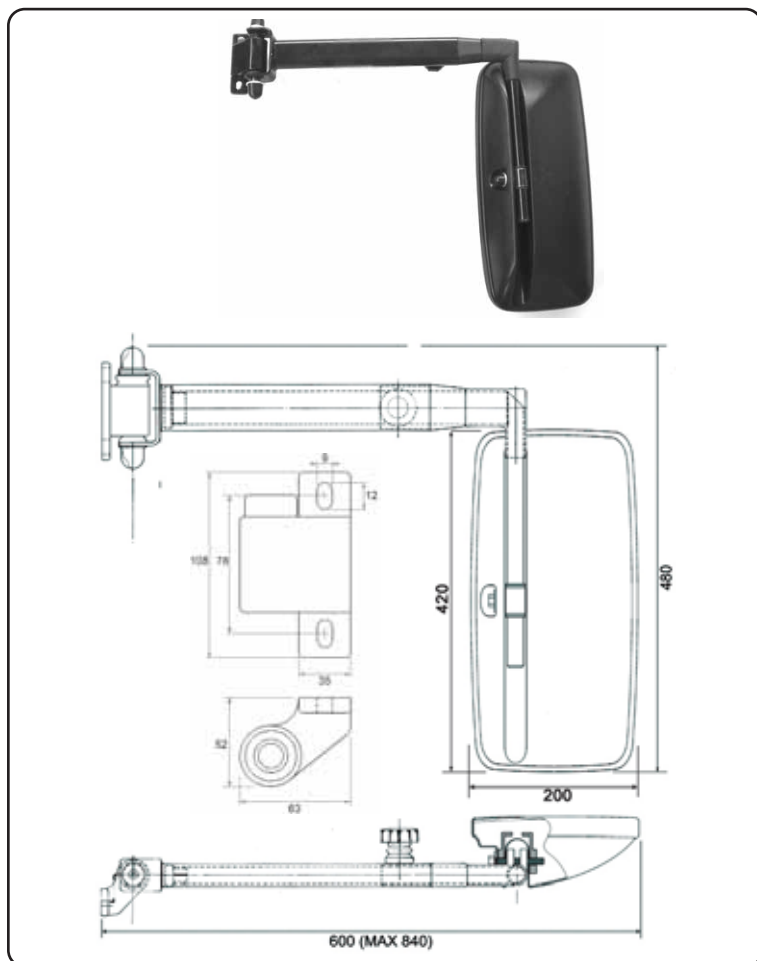

Immagini articoli sinistri / Images of left items

788.ND				mm 440-670 Ø18
788.NS				mm 440-670 Ø18
954.N				mm 420x200
1078.N				mm 408x185,5

#### APPLICAZIONI / APPLICATIONS

RENAULT

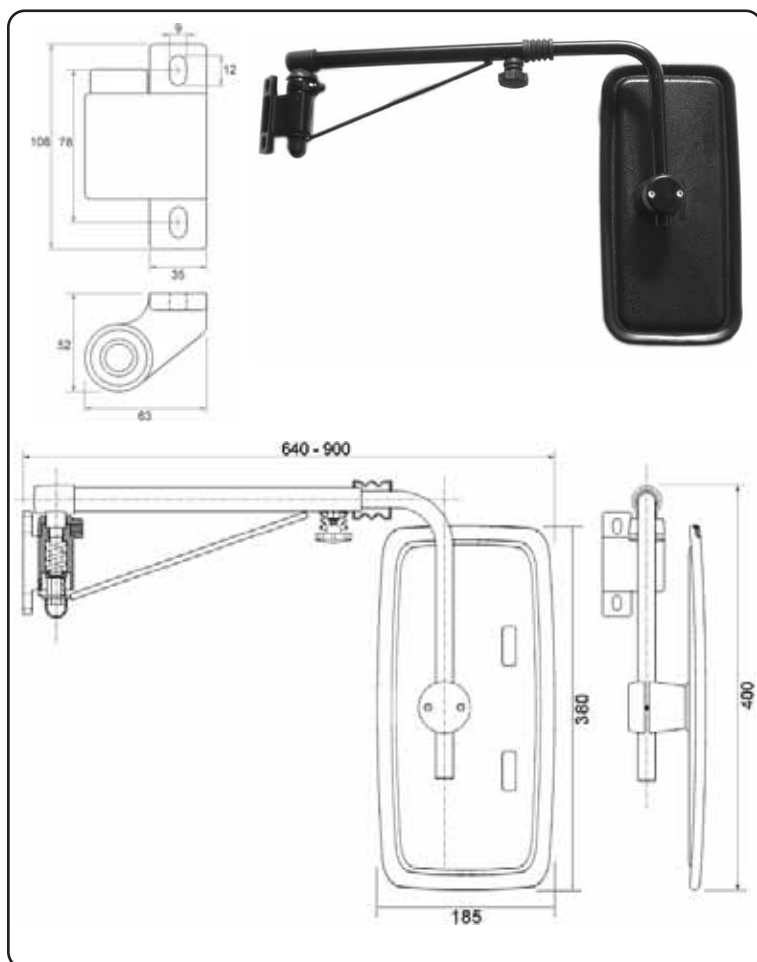

Immagini articoli sinistri / Images of left items

719.ND				mm 450-670 Ø18
719.NS				mm 450-670 Ø18
933.N				mm 380x185
1070.N				mm 366x176

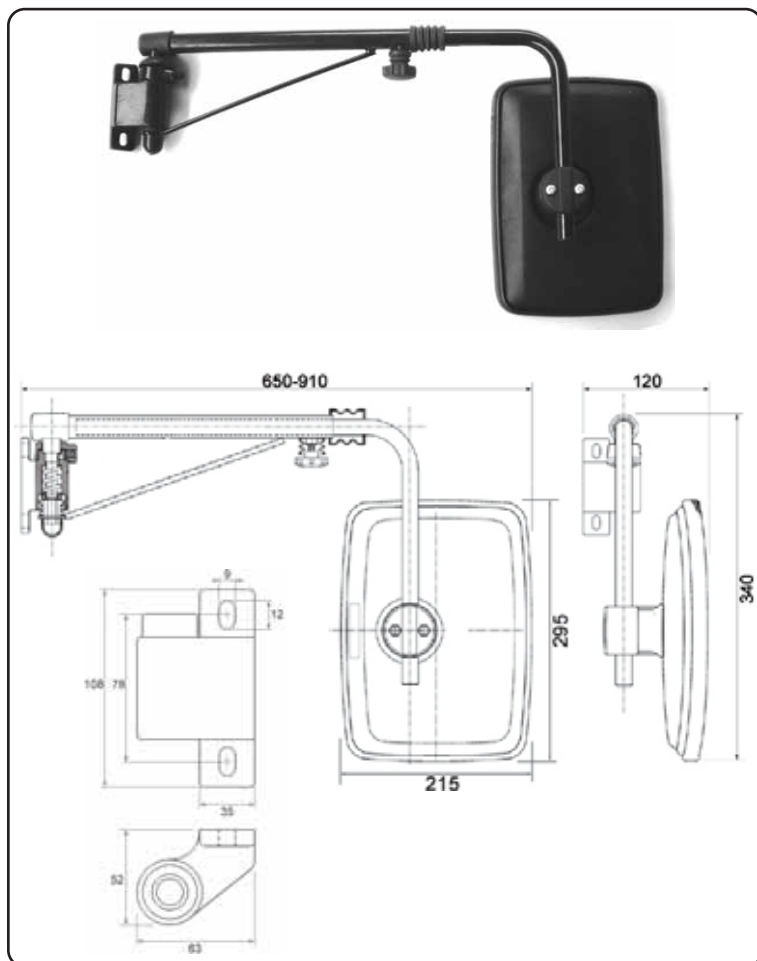

Immagini articoli sinistri / Images of left items

719.NS				mm 450-670 Ø20
829.N				mm 215x295
1072.N				mm 280x200

	AMBIDESTRO AMBIDEXTROUS		DESTRO RIGHT		SINISTRO LEFT		COMPLETO COMPLET		COPPA HEAD		BRACCIO ARM		VETRO GLASS		NERO BLACK		TERMICO 12V THERMIC 12V
--	----------------------------	--	-----------------	--	------------------	--	---------------------	--	---------------	--	----------------	--	----------------	--	---------------	--	----------------------------

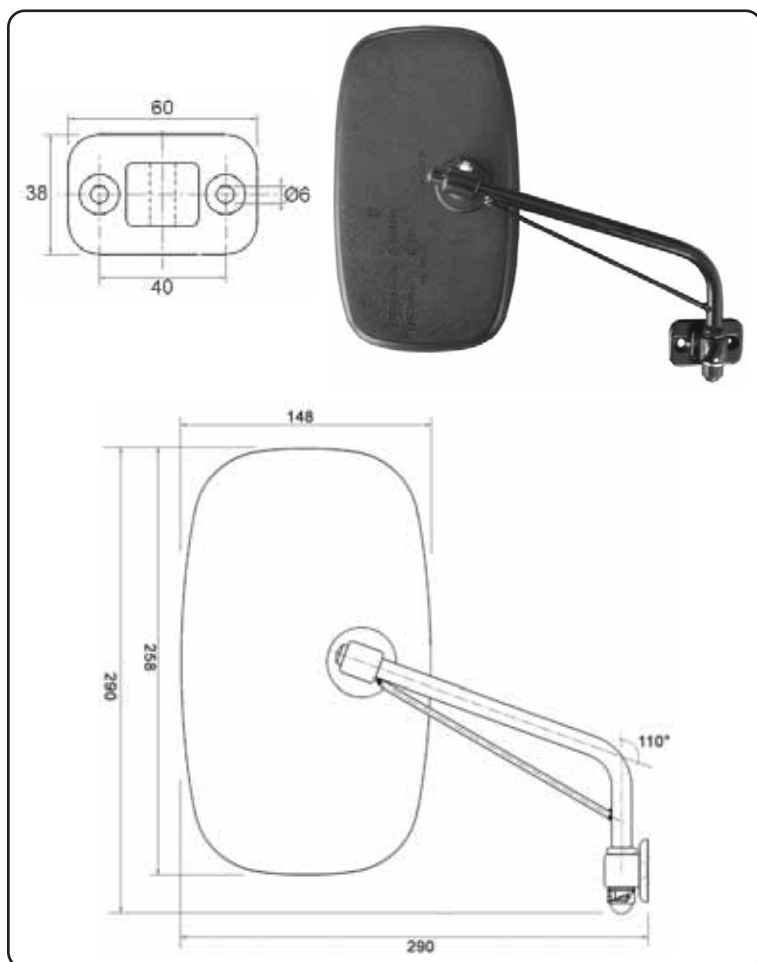

Immagini articoli ambidestri / Images of ambidextrous items

846.N    mm 200 Ø12

886.N    mm 258x148

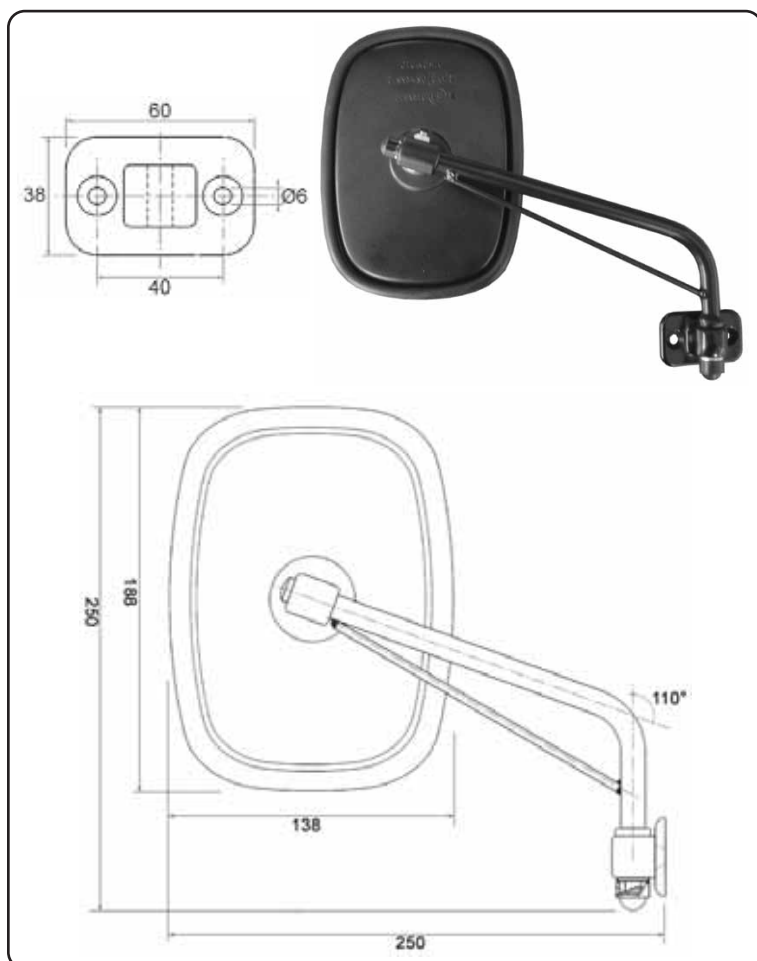

Immagini articoli ambidestri / Images of ambidextrous items

846.N    mm 200 Ø12

641.N    mm 188x138

1051.N   mm 179x131

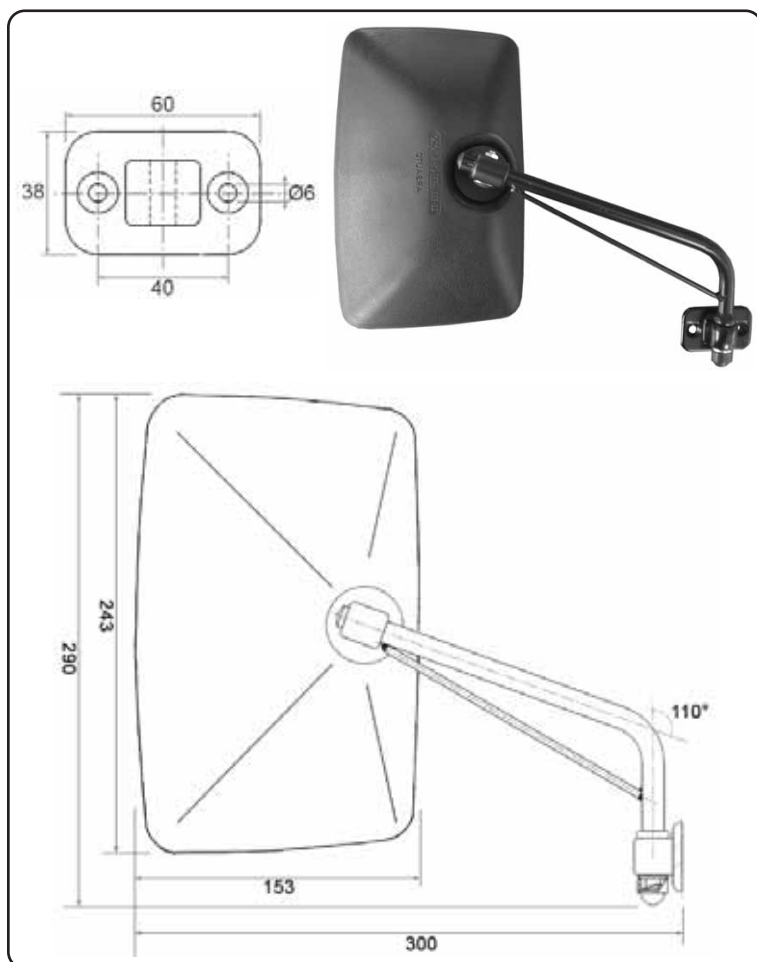

Immagini articoli ambidestri / Images of ambidextrous items

846.N



mm 200 Ø12

697.N



mm 243x153

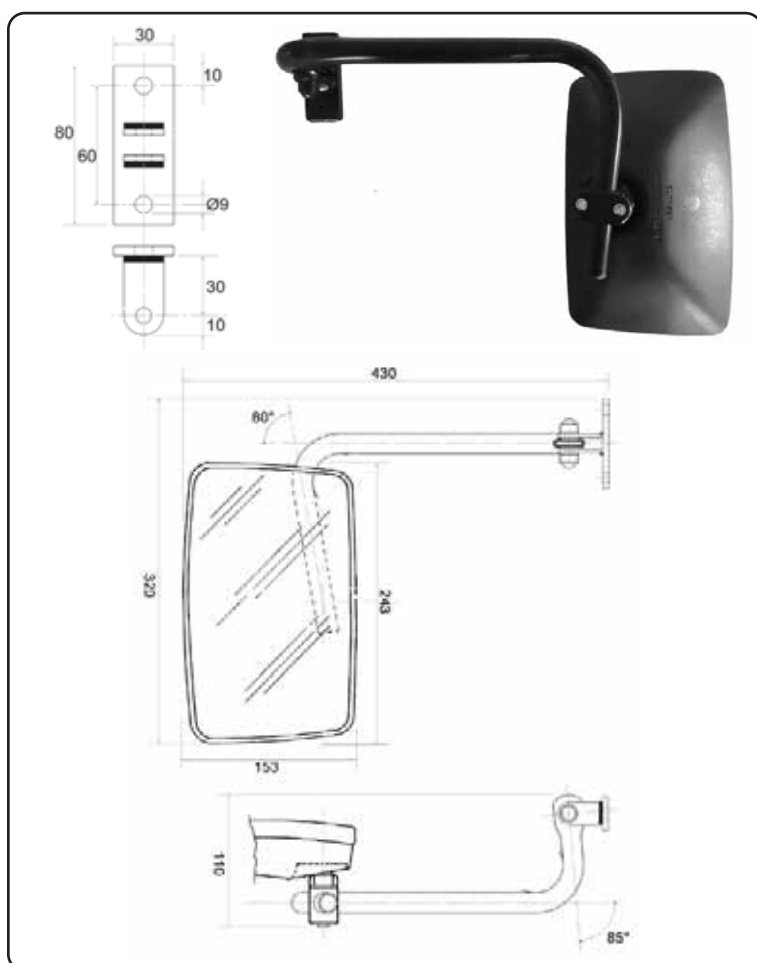

Immagini articoli sinistri / Images of left items

710.ND



mm 250 Ø18

710.NS



mm 250 Ø18

672.N



mm 245x155

## APPLICAZIONI / APPLICATIONS

CESAB



AMBIDESTRO  
AMBIDEXTROUS



DESTRO  
RIGHT



SINISTRO  
LEFT



COMPLETO  
COMPLET



COPPA  
HEAD



BRACCIO  
ARM



VETRO  
GLASS



NERO  
BLACK



TERMICO 12V  
THERMIC 12V



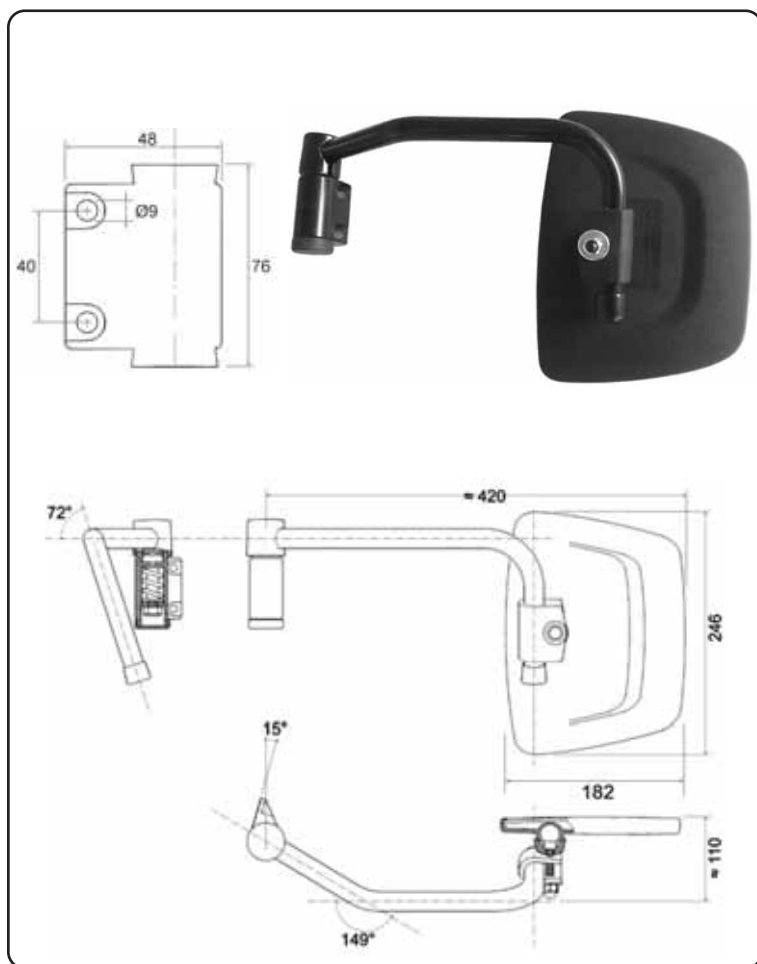

Immagini articoli sinistri / Images of left items

643.ND				mm 280 Ø20
643.NS				mm 280 Ø20
662.N				mm 246x182

#### APPLICAZIONI / APPLICATIONS

CARRARO AGRITALIA

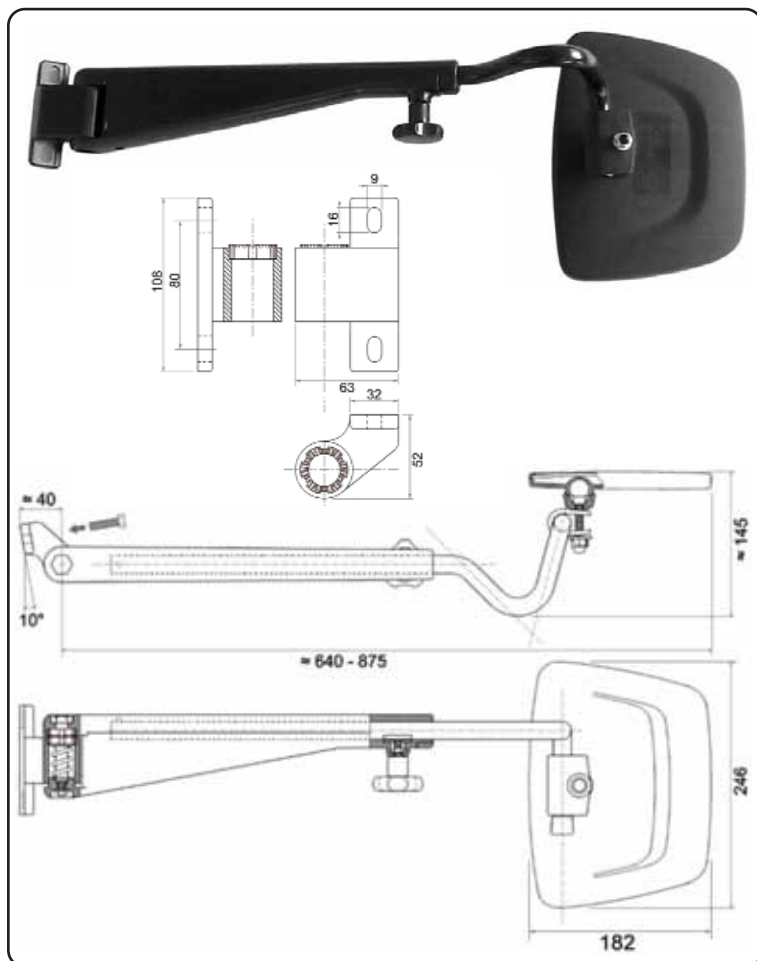

Immagini articoli sinistri / Images of left items

693.ND				mm 530-770 Ø18
693.NS				mm 530-770 Ø18
662.N				mm 246x182

#### APPLICAZIONI / APPLICATIONS

LANDINI

	AMBIDESTRO AMBIDEXTROUS		DESTRO RIGHT		SINISTRO LEFT		COMPLETO COMPLET		COPPA HEAD		BRACCIO ARM		VETRO GLASS		NERO BLACK		TERMICO 12V THERMIC 12V
--	----------------------------	--	-----------------	--	------------------	--	---------------------	--	---------------	--	----------------	--	----------------	--	---------------	--	----------------------------

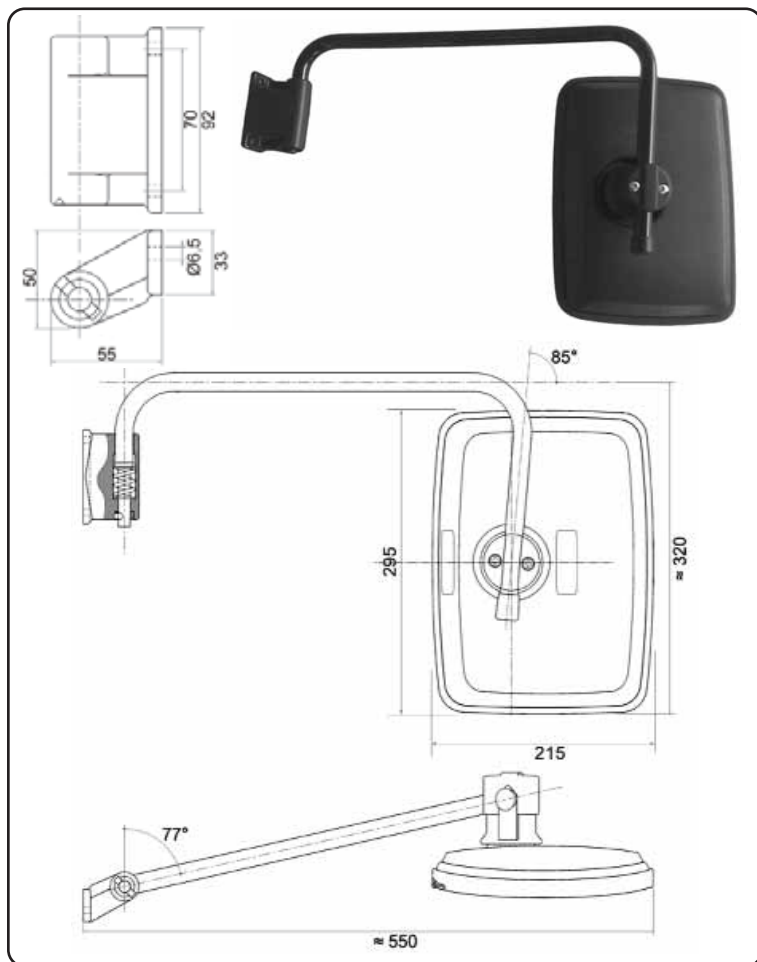

Immagini articoli sinistri / Images of left items

666.ND				mm 440 Ø18
666.NS				mm 440 Ø18
829.N				mm 295x215
1072.N				mm 280x200

#### APPLICAZIONI / APPLICATIONS

JOHN DEERE

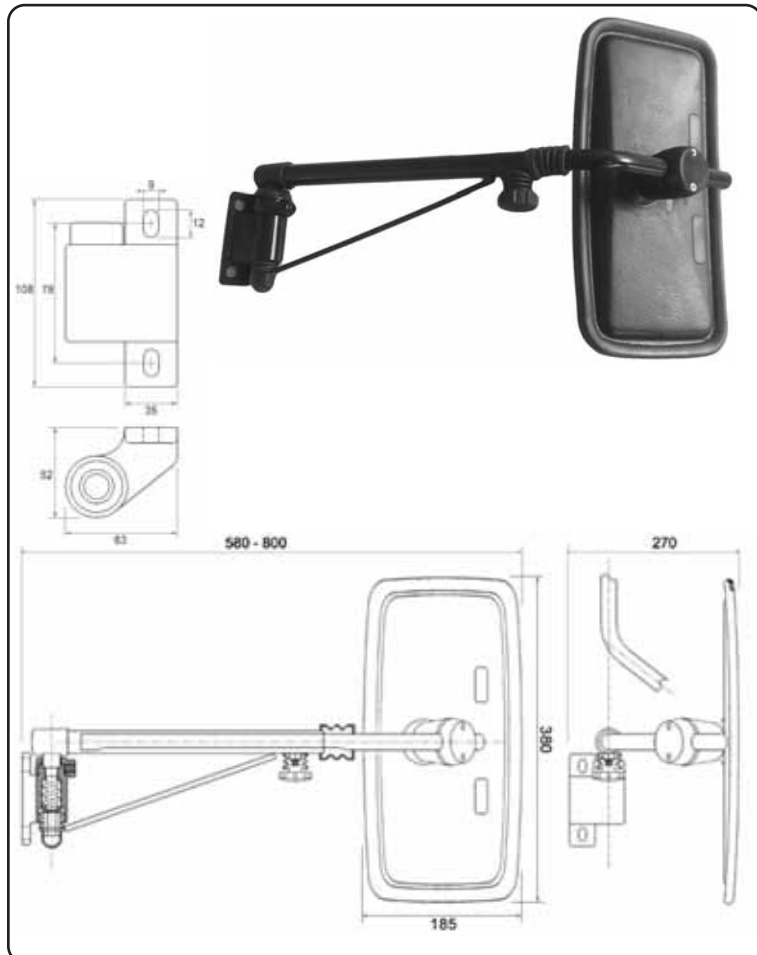

Immagini articoli sinistri / Images of left items

677.ND				mm 490-710 Ø20
677.NS				mm 490-710 Ø20
933.N				mm 380x185
1070.N				mm 368x173

#### APPLICAZIONI / APPLICATIONS

SAME-DEUTZ

	AMBIDESTRO AMBIDEXTROUS		DESTRO RIGHT		SINISTRO LEFT		COMPLETO COMPLET		COPPA HEAD		BRACCIO ARM		VETRO GLASS		NERO BLACK		TERMICO 12V THERMIC 12V
--	----------------------------	--	-----------------	--	------------------	--	---------------------	--	---------------	--	----------------	--	----------------	--	---------------	--	----------------------------

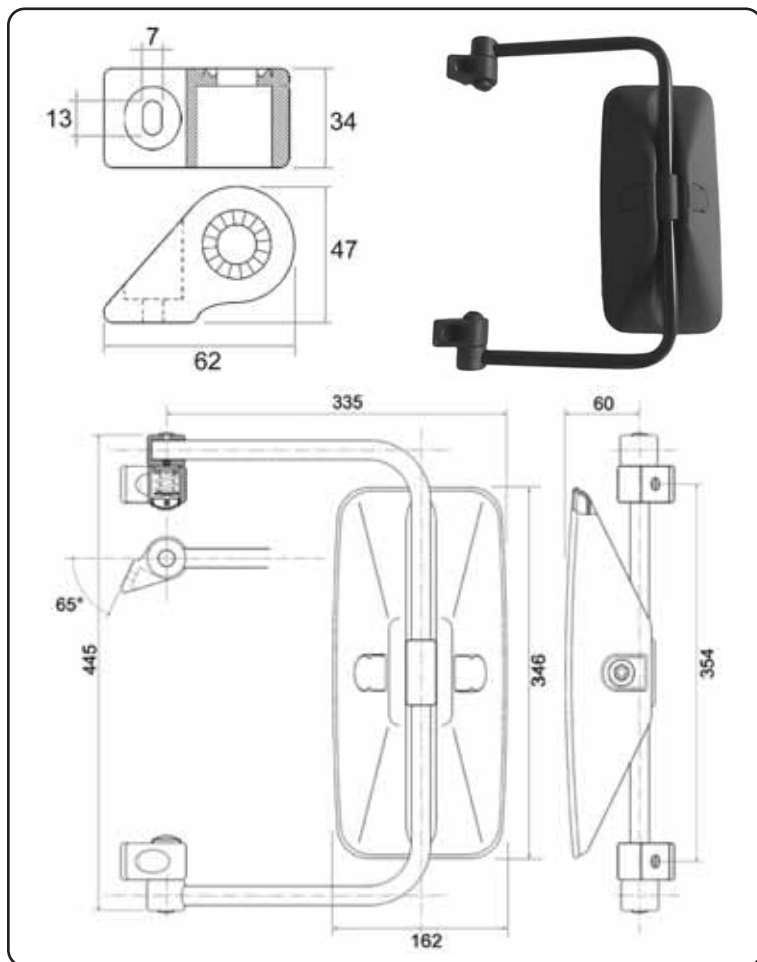

Immagini articoli ambidestri / Images of ambidextrous items

695.N    mm 270 Ø20

916.N    mm 346x162

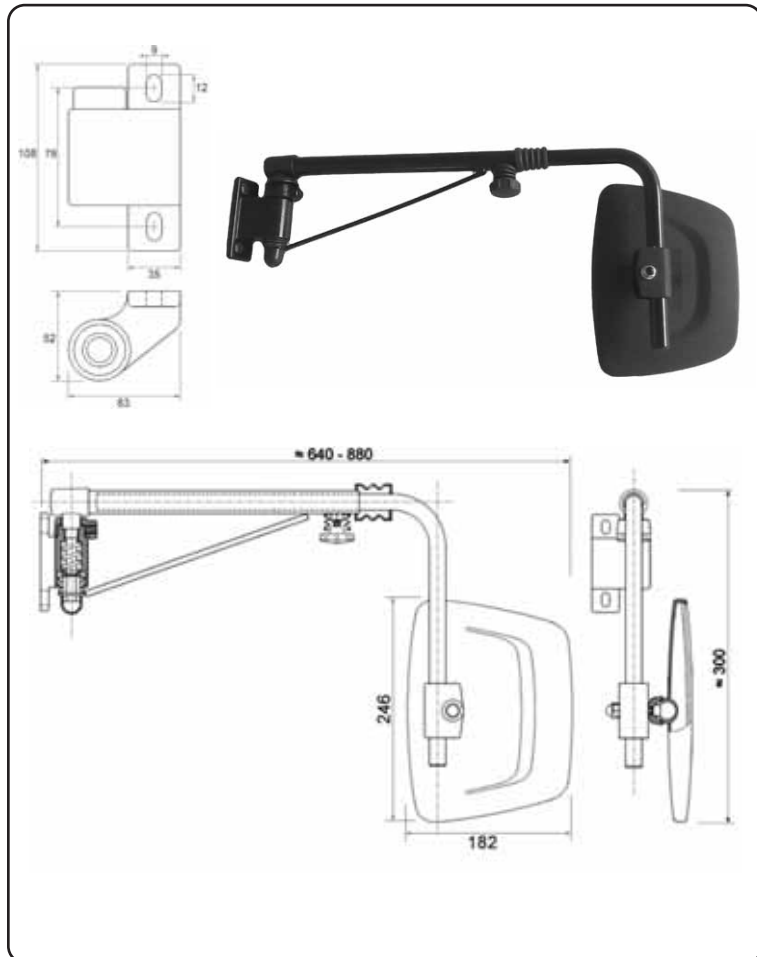

Immagini articoli sinistri / Images of left items

719.ND    mm 450-670 Ø20

719.NS    mm 450-670 Ø20

662.N    mm 246x182

## APPLICAZIONI / APPLICATIONS

CARRARO AGRITALIA

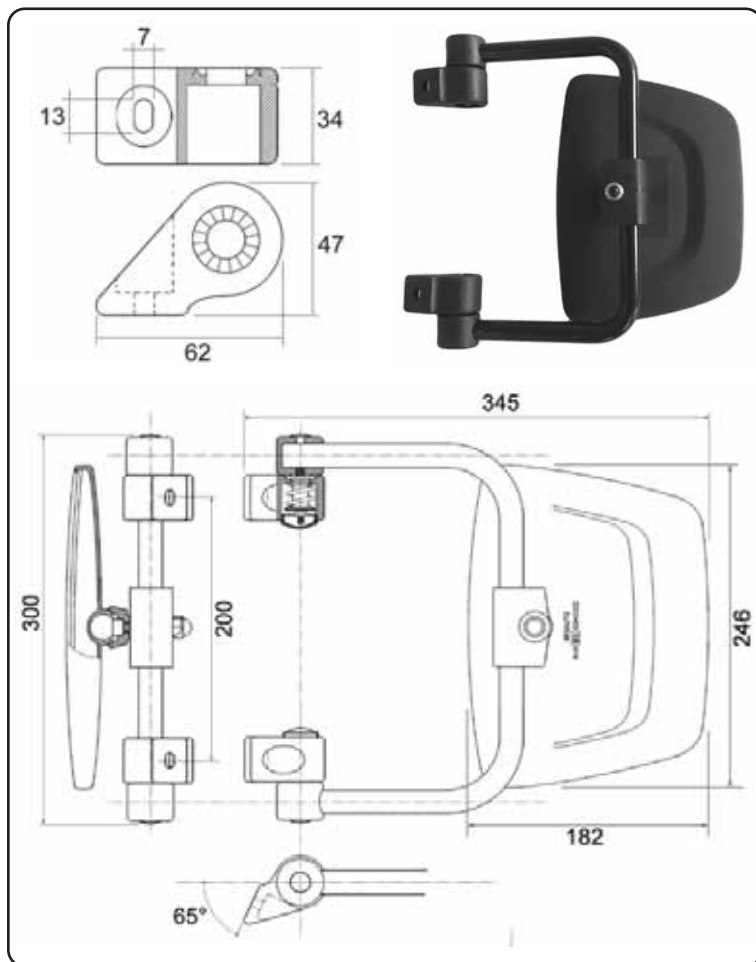

Immagini articoli ambidestri / Images of ambidextrous items

705.N



mm 180 Ø20

662.N



mm 246x182

#### APPLICAZIONI / APPLICATIONS

CARRARO AGRITALIA

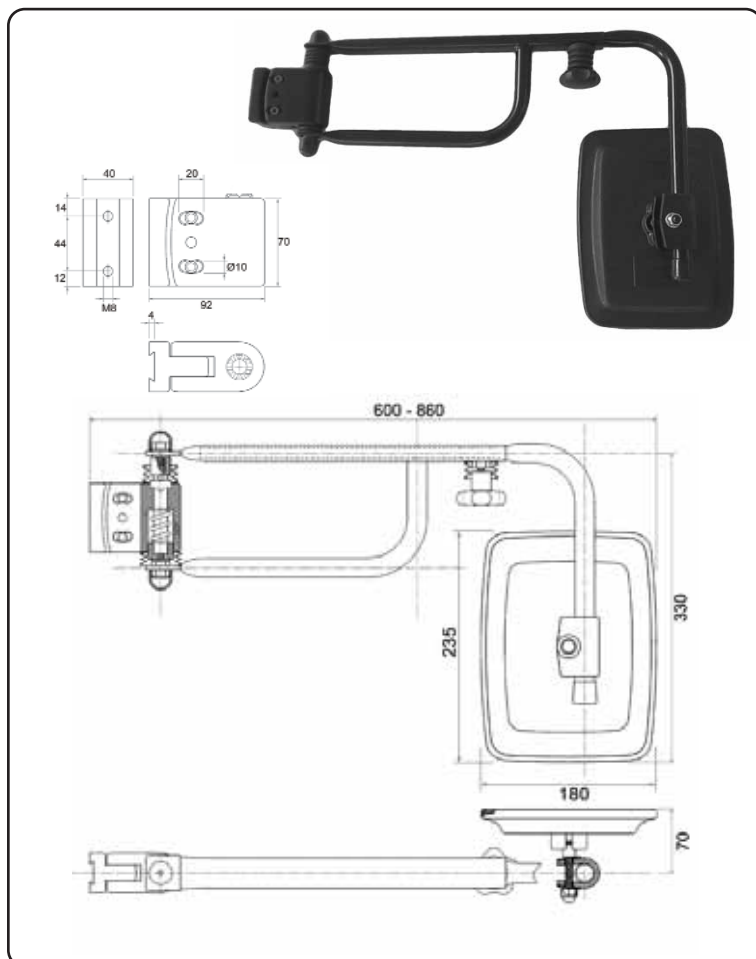

Immagini articoli ambidestri / Images of ambidextrous items

790.N



mm 510-770 Ø20

779.N



mm 235x180

#### APPLICAZIONI / APPLICATIONS

CASE  
NEW HOLLAND



AMBIDESTRO  
AMBIDEXTROUS



DESTRO  
RIGHT



SINISTRO  
LEFT



COMPLETO  
COMPLET



COPPA  
HEAD



BRACCIO  
ARM



VETRO  
GLASS



NERO  
BLACK



TERMICO 12V  
THERMIC 12V

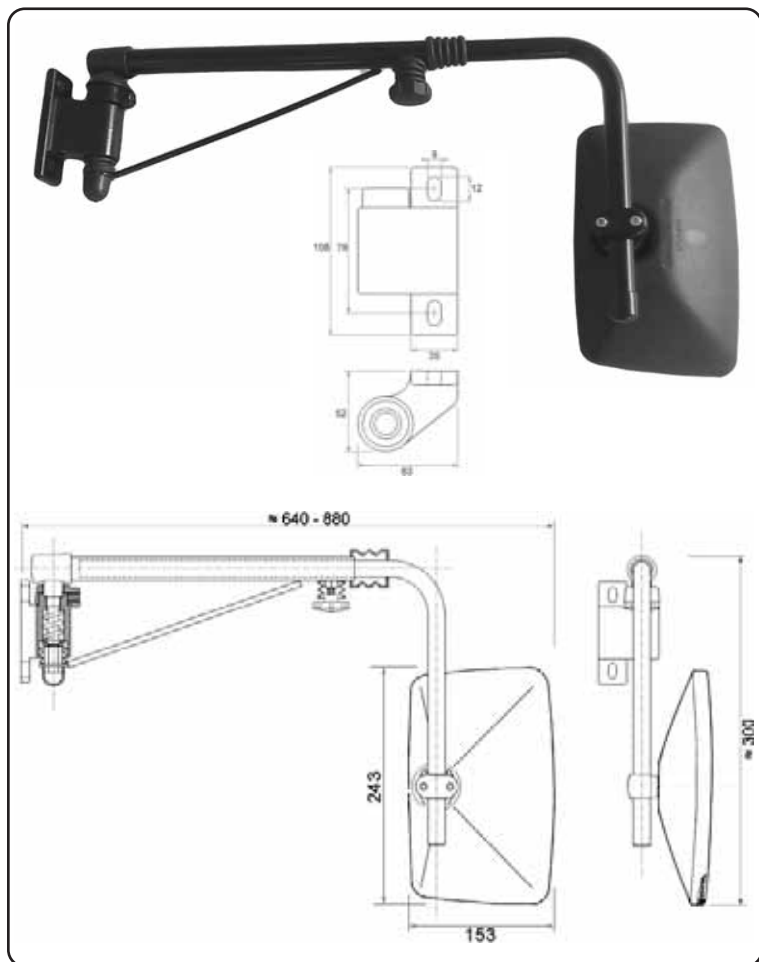

Immagini articoli sinistri / Images of left items

719.ND				mm 450-670 Ø20
719.NS				mm 450-670 Ø20
672.N				mm 243x153

#### APPLICAZIONI / APPLICATIONS

RENAULT

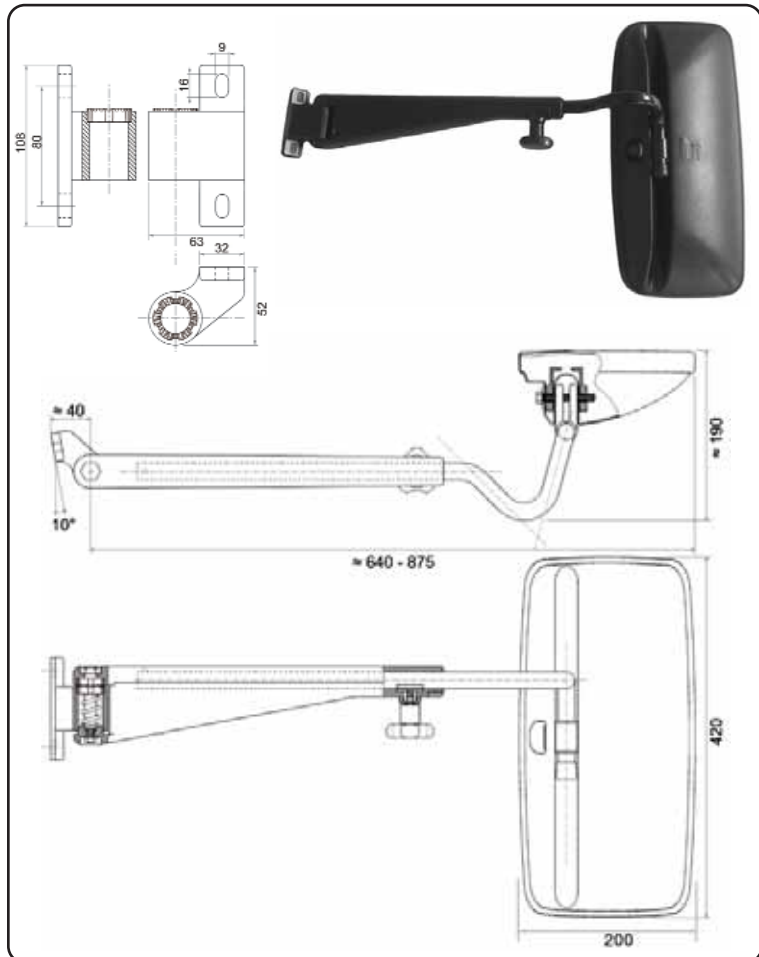

Immagini articoli sinistri / Images of left items

693.ND				mm 530-770 Ø18
693.NS				mm 530-770 Ø18
954.N				mm 420x200
1078.N				mm 408x185,5

#### APPLICAZIONI / APPLICATIONS

RENAULT

	AMBIDESTRO AMBIDEXTROUS		DESTRO RIGHT		SINISTRO LEFT		COMPLETO COMPLET		COPPA HEAD		BRACCIO ARM		VETRO GLASS		NERO BLACK		TERMICO 12V THERMIC 12V
--	----------------------------	--	-----------------	--	------------------	--	---------------------	--	---------------	--	----------------	--	----------------	--	---------------	--	----------------------------

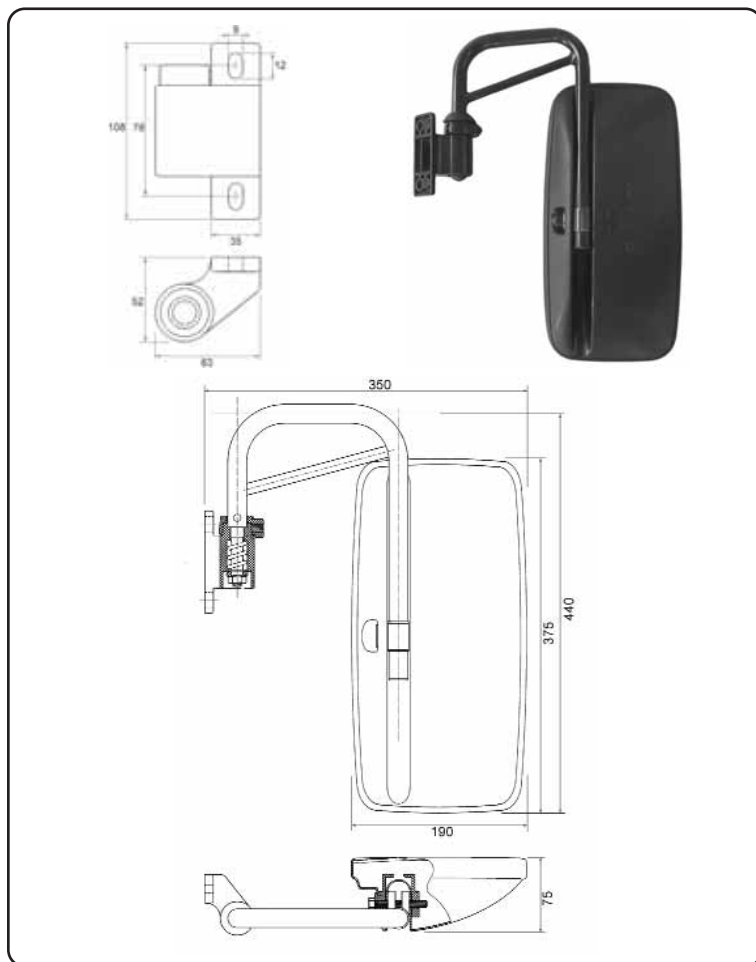

Immagini articoli sinistri / Images of left items

961E.NS				mm 200 Ø20
952.N				mm 375x190
1076.N				mm 360x174

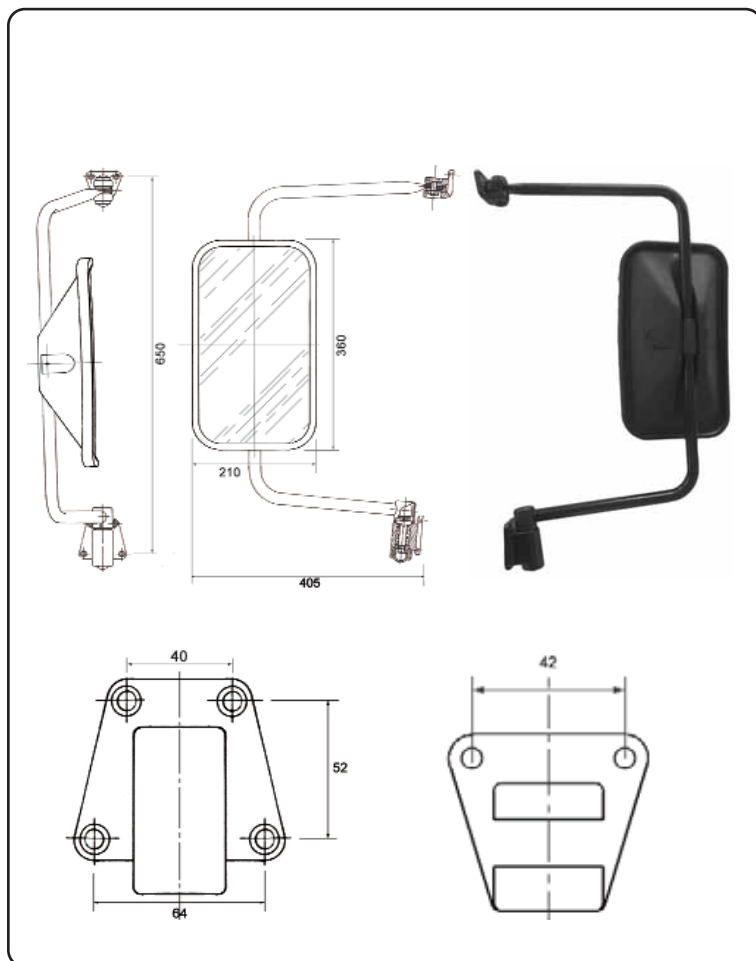

Immagini articoli sinistri / Images of left items

901.NS				mm 350 Ø20
902.N				mm 360x210
1059.N				mm 345x196

	AMBIDESTRO AMBIDEXTROUS		DESTRO RIGHT		SINISTRO LEFT		COMPLETO COMPLET		COPPA HEAD		BRACCIO ARM		VETRO GLASS		NERO BLACK		TERMICO 12V THERMIC 12V
--	----------------------------	--	-----------------	--	------------------	--	---------------------	--	---------------	--	----------------	--	----------------	--	---------------	--	----------------------------



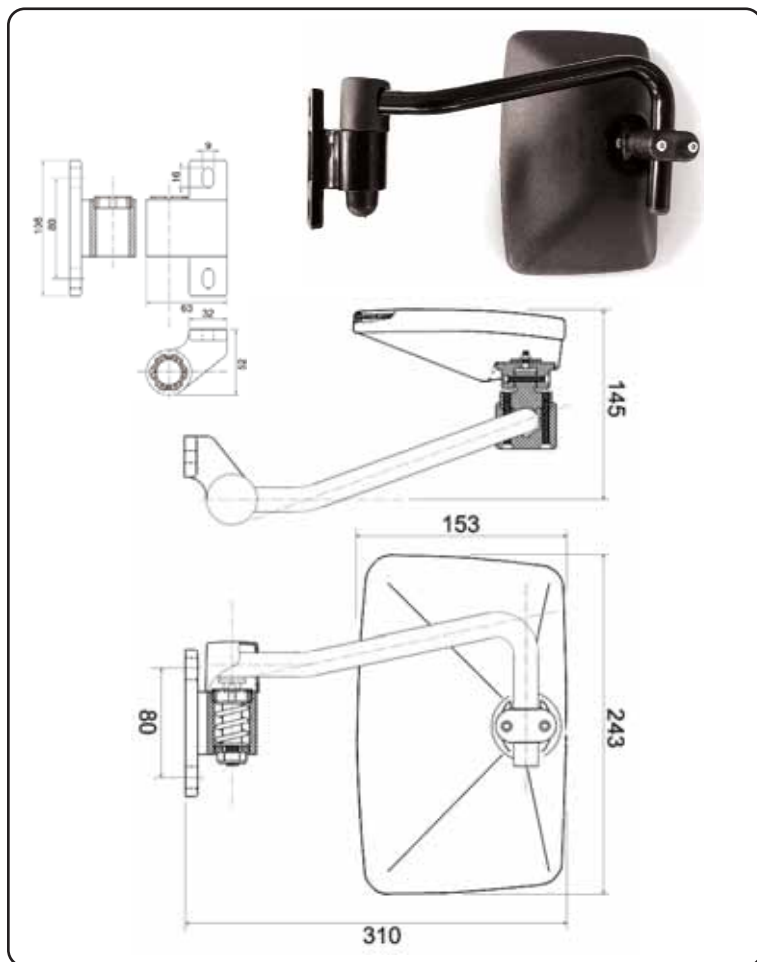

Immagini articoli sinistri / Images of left items

621.ND				mm 264 Ø20
621.NS				mm 264 Ø20
672.N				mm 243x153

#### APPLICAZIONI / APPLICATIONS

CLAAS  
RENAULT

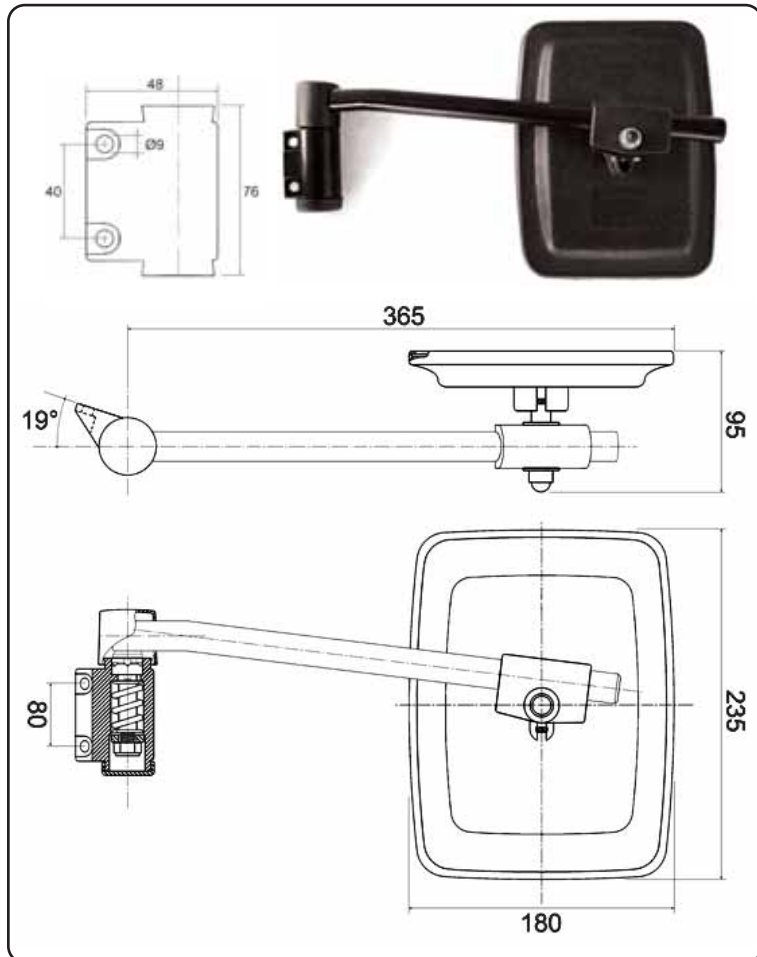

Immagini articoli sinistri / Images of left items

675.ND				mm 332 Ø20
675.NS				mm 332 Ø20
779.N				mm 235x180

#### APPLICAZIONI / APPLICATIONS

HURLIMAN  
LAMBORGHINI  
SAME-DEUTZ

	AMBIDESTRO AMBIDEXTROUS		DESTRO RIGHT		SINISTRO LEFT		COMPLETO COMPLET		COPPA HEAD		BRACCIO ARM		VETRO GLASS		NERO BLACK		TERMICO 12V THERMIC 12V
--	----------------------------	--	-----------------	--	------------------	--	---------------------	--	---------------	--	----------------	--	----------------	--	---------------	--	----------------------------

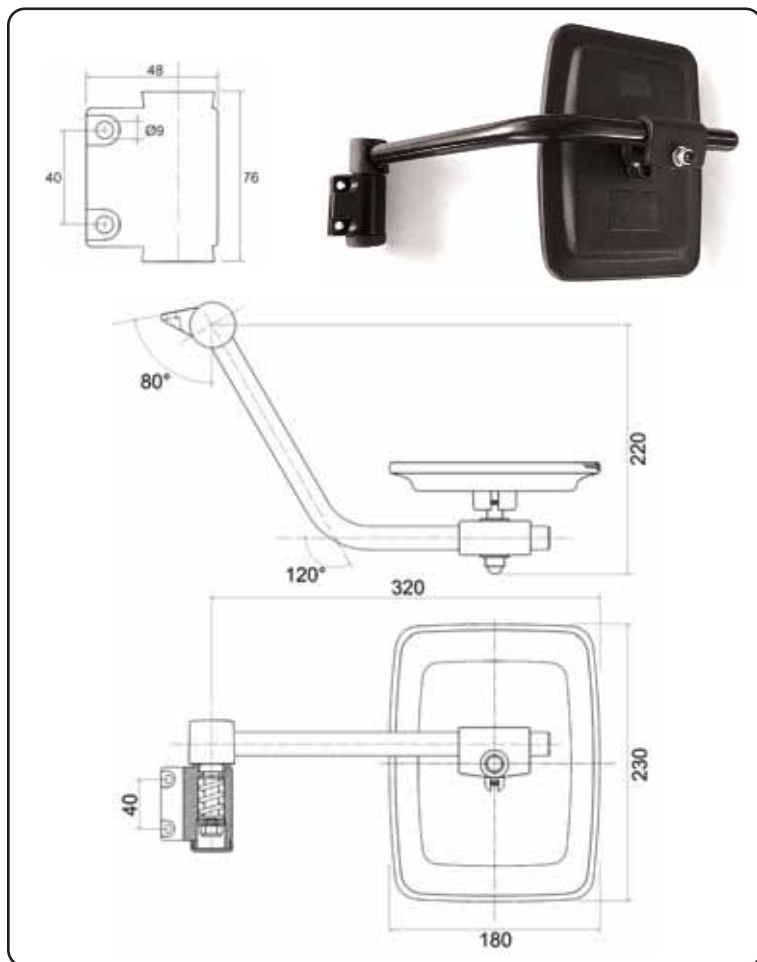

Immagini articoli sinistri / Images of left items

678.ND				mm 285 Ø20
678.NS				mm 285 Ø20
779.N				mm 235x180

#### APPLICAZIONI / APPLICATIONS

BRIEDA  
HURLIMAN  
JOHN DEERE  
LAMBORGHINI  
MASSEY FERGUSON  
SAME-DEUTZ

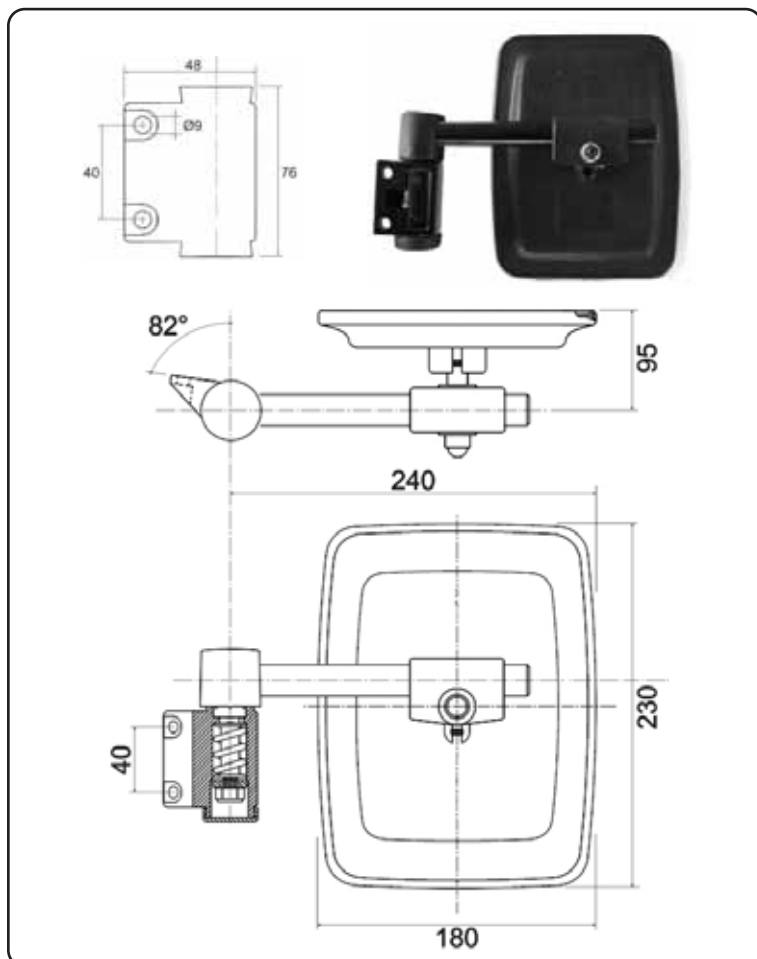

Immagini articoli sinistri / Images of left items

685.ND				mm 190 Ø20
685.NS				mm 190 Ø20
779.N				mm 235x180

#### APPLICAZIONI / APPLICATIONS

CNH  
LANDINI  
Mc CORMICK  
VAL PADANA

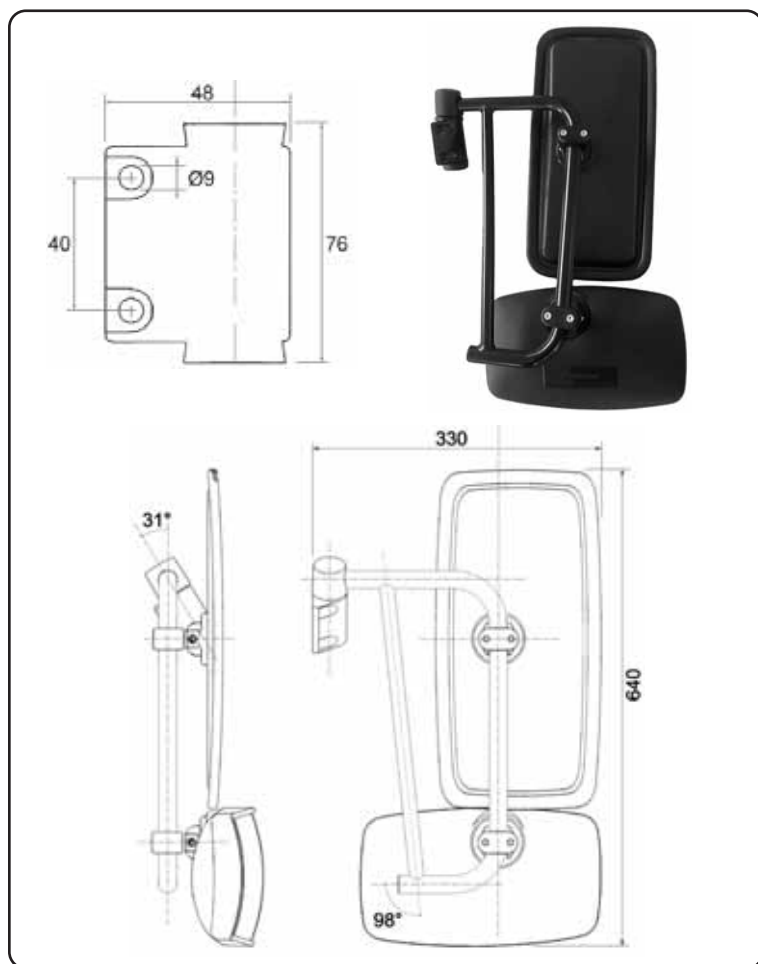

Immagini articoli sinistri / Images of left items

994.ND				mm 220 Ø20
994.NS				mm 220 Ø20
932.N				mm 380x185
1070.N				mm 368x173
958.NO				mm 260x155

#### APPLICAZIONI / APPLICATIONS

SICAS

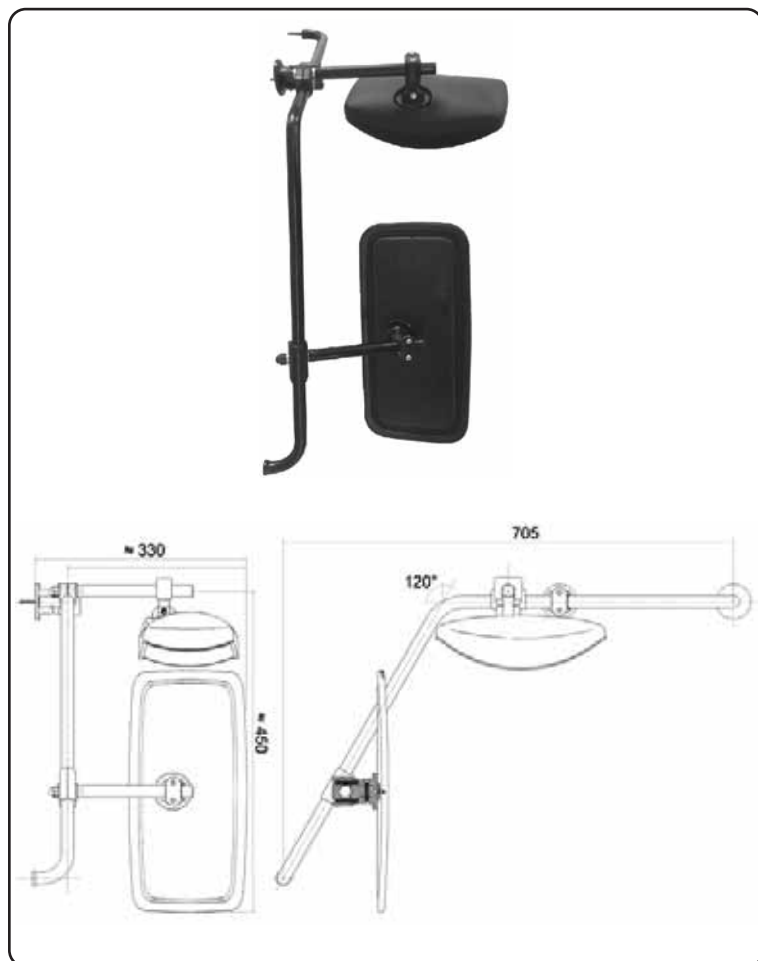

Immagini articoli sinistri / Images of left items

664.ND				mm 250 Ø18
664.NS				mm 250 Ø18
932.N				mm 380x185
1070.N				mm 368x173
958.NO				mm 260x155

#### APPLICAZIONI / APPLICATIONS

SICAS

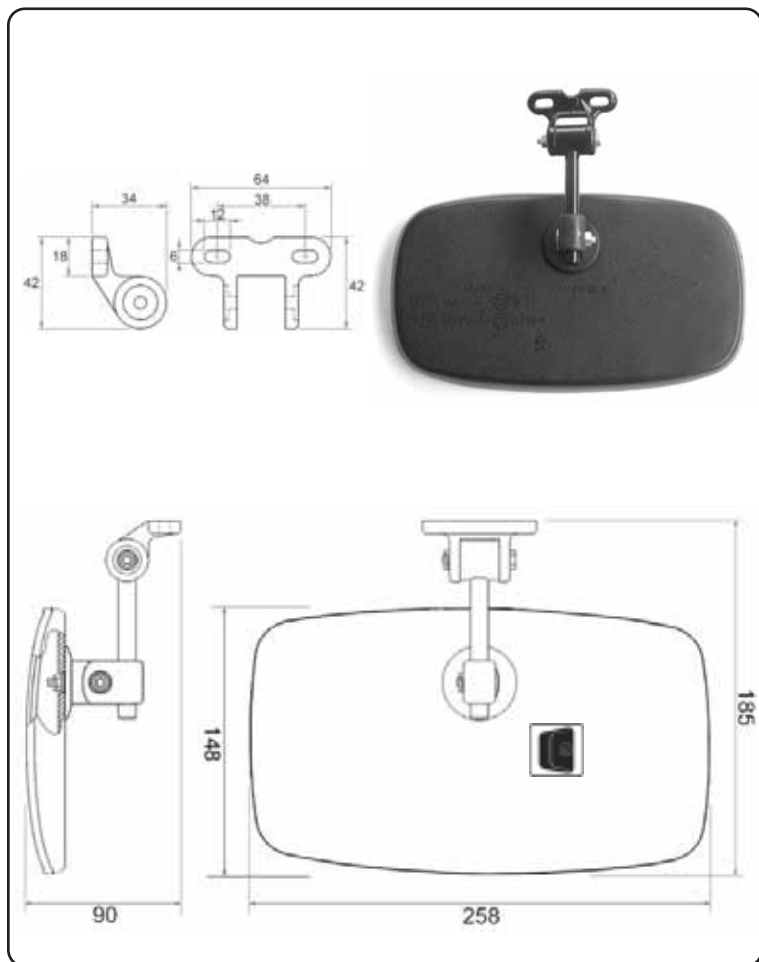

## RETROVISORE INTERNO / INTERNAL MIRROR

698.N



mm 258x148

892.N



mm 258x148

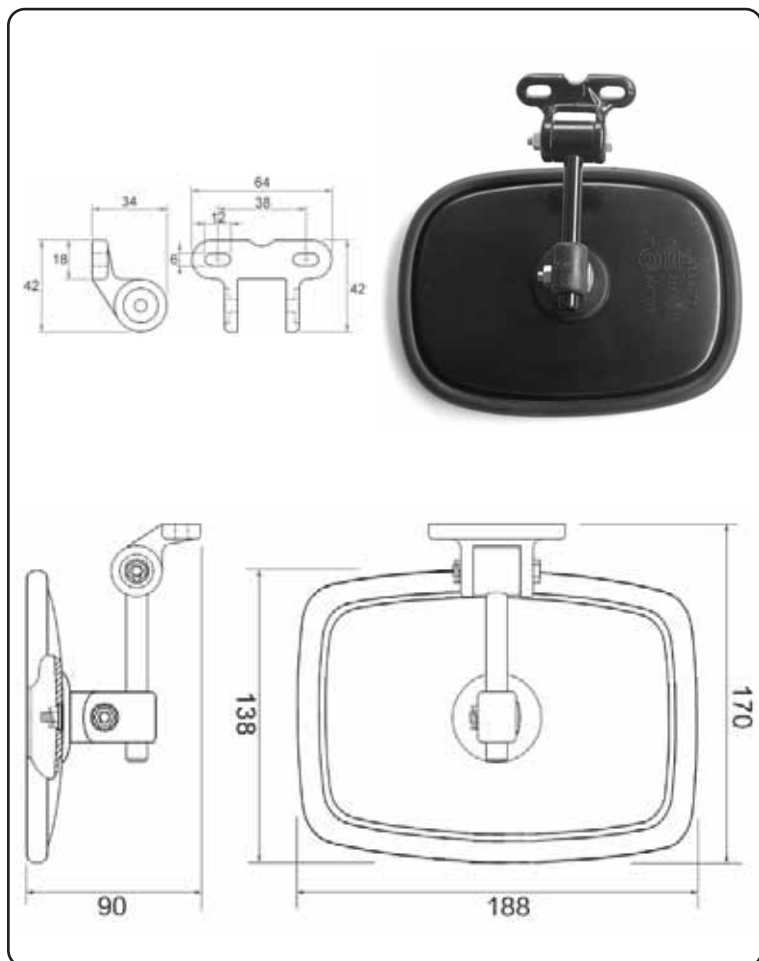

## RETROVISORE INTERNO / INTERNAL MIRROR

889.N



mm 188x138

649.N



mm 188x138

1051.N



mm 179x131



AMBIDESTRO  
AMBIDEXTROUS



DESTRO  
RIGHT



SINISTRO  
LEFT



COMPLETO  
COMPLET



COPPA  
HEAD



BRACCIO  
ARM



VETRO  
GLASS



NERO  
BLACK



TERMICO 12V  
THERMIC 12V



#### COPPA RICAMBIO / REPLACEMENT HEAD

779.N				mm 235x180 Fix Ø 18-20
779.NT				mm 235x180 Fix Ø 18-20

#### APPLICAZIONI / APPLICATIONS

CARRARO AGRITALIA  
CASE-IH  
FIAT  
HURLIMAN  
LAMBORGHINI  
LANDINI  
MASSEY FERGUSON  
Mc CORMICK

MERLO  
NEW HOLLAND  
RENAULT  
SAME-DEUTZ



#### COPPA RICAMBIO / REPLACEMENT HEAD

672.N				mm 243x153 Fix Ø 14-20
672.NT				mm 243x153 Fix Ø 14-20

#### APPLICAZIONI / APPLICATIONS

CASE-IH  
CESAB  
CLAAS  
MANITOU  
MASSEY FERGUSON  
NK BIKE  
RENAULT



#### COPPA RICAMBIO / REPLACEMENT HEAD

941.N				mm 318x230 Fix Ø 18-20
1248.N				mm 302x214
941.NT				mm 318x230 Fix Ø 18-20
1248.T				mm 302x214

#### APPLICAZIONI / APPLICATIONS

FENDT  
LANDINI  
SAME-DEUTZ



#### COPPA RICAMBIO / REPLACEMENT HEAD

954.N				mm 420x200 Fix Ø 18
1078.N				mm 407x183
954.NT				mm 420x200 Fix Ø 18
1078.T				mm 408x185,5

#### APPLICAZIONI / APPLICATIONS

RENAULT



#### COPPA RICAMBIO / REPLACEMENT HEAD

932.N				mm 380x185 Fix Ø 16-20
1070.N				mm 368x173
932.NT				mm 380x185 Fix Ø 16-20
1070.T				mm 368x173

#### APPLICAZIONI / APPLICATIONS

SICAS



#### COPPA RICAMBIO / REPLACEMENT HEAD

933.N				mm 380x185 Fix Ø 16-20
1070.N				mm 368x173
933.NT				mm 380x185 Fix Ø 16-20
1070.T				mm 368x173

#### APPLICAZIONI / APPLICATIONS

SAME-DEUTZ



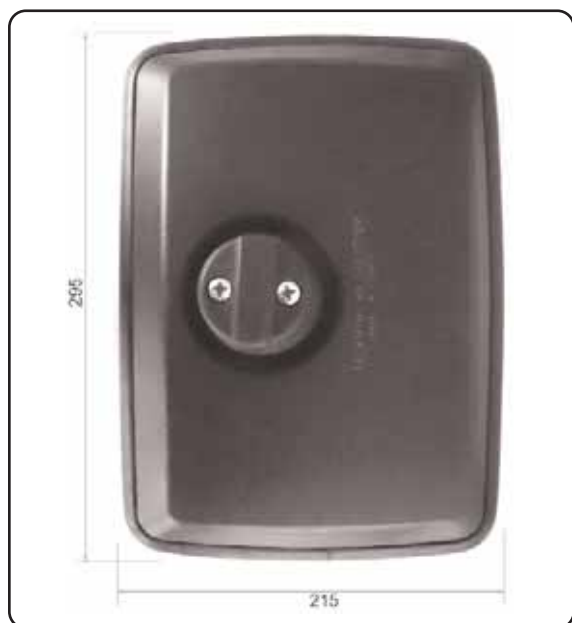

#### COPPA RICAMBIO / REPLACEMENT HEAD

829.N				mm 295x215 Fix Ø 16-20
1072.N				mm 280x200
829.NT				mm 295x215 Fix Ø 16-20
1072.T				mm 280x200

#### APPLICAZIONI / APPLICATIONS

JOHN DEERE



#### COPPA RICAMBIO / REPLACEMENT HEAD

886.N				mm 258x148 Fix Ø 10-12-13
886.NT				mm 258x148 Fix Ø 10-12-13

#### APPLICAZIONI / APPLICATIONS

CASE-IH  
SAME-DEUTZ



#### COPPA RICAMBIO / REPLACEMENT HEAD

641.N				mm 188x138 Fix Ø 10-12
1051.N				mm 179x131



#### COPPA RICAMBIO / REPLACEMENT HEAD

662.N				mm 246x182 Fix Ø 18-20
662.NT				mm 246x182 Fix Ø 18-20

#### APPLICAZIONI / APPLICATIONS

CARRARO AGRITALIA  
JOHN DEERE  
LANDINI  
MANITOU



#### COPPA RICAMBIO / REPLACEMENT HEAD

916.N				mm 346x162 Fix Ø 20
916.NT				mm 346x162 Fix Ø 20



#### COPPA RICAMBIO / REPLACEMENT HEAD

952.N				mm 375x190 Fix Ø 18
1076.N				mm 360x174
952.NT				mm 375x190 Fix Ø 18
1076.T				mm 360x174



#### COPPA RICAMBIO / REPLACEMENT HEAD

902.N	◀▶	COMPLETO	NERO	mm 360x210 Fix Ø 20
1059.N	◀▶	COMPLETO	NERO	mm 334x194
902.NT	◀▶	COMPLETO	NERO	12V mm 360x210 Fix Ø 20
1059.T	◀▶	COMPLETO	NERO	12V mm 345x196

#### APPLICAZIONI / APPLICATIONS

MERLO



#### COPPA RICAMBIO / REPLACEMENT HEAD

958.NO	◀▶	COMPLETO	NERO	mm 260x155 Fix Ø 16-20
958.NTO	◀▶	COMPLETO	NERO	12V mm 260x155 Fix Ø 16-20

#### APPLICAZIONI / APPLICATIONS

SICAS



#### COPPA RICAMBIO / REPLACEMENT HEAD

649.N	◀▶	COMPLETO	NERO	mm 188x138 Fix Ø 10
1051.N	◀▶	COMPLETO	NERO	mm 179x131



## COPPA RICAMBIO / REPLACEMENT HEAD

892.N



mm 258x148 Fix Ø 10

## INDICE ARSAUTO / ARSAUTO INDEX

621.ND	18	705.N	15	788.NS	8	954.NT	23
621.NS	18	710.ND	11	790.N	15	958.NO	26
641.N	24	710.NS	11	829.N	24	958.NTO	26
643.ND	12	710B.ND	5	829.NT	24	961E.NS	17
643.NS	12	710B.NS	5	846.N	10	994.ND	20
649.N	26	711.NS	2	886.N	24	994.NS	20
662.N	25	716.ND	2-5	886.T	24	1051.N	24
662.1140	25	716.NS	2-5	889.N	21	1059.N	26
664.ND	20	717.ND	1	892.N	27	1059.N	26
664.NS	20	717.NS	1	901.NS	17	1070.N	23
666.ND	13	719.ND	4	902.N	26	1070.T	23
666.NS	13	719.NS	4	902.NT	26	1072.N	24
672.N	22	725.N	3	916.N	25	1072.T	24
672.NT	22	728.ND	7	916.NT	25	1076.N	25
675.ND	18	728.NS	7	916.NT	4	1076.T	25
675.NS	18	731.ND	6	928.N	23	1078.N	23
677.ND	13	731.NS	6	932.N	23	1078.T	23
677.NS	13	738B.ND	7	932.NT	23	1248.N	22
678.ND	19	738B.NS	7	933.N	23	1248.T	22
678.NS	19	770.NS	6	933.NT	22		
685.ND	19	778.ND	3	941.N	22		
685.NS	19	778.NS	3	941.NT	8		
693.ND	12	779.N	22	942.ND	8		
693.NS	12	779.NT	22	942.NS	25		
695.N	14	786.ND	1	952.1N	25		
697.N	11	786.NS	1	952.NT	23		
698.N	21	788.ND	8	954.N			

# INDICE O.E. / O.E. INDEX

## **CARRARO** **AGRITALIA**

121412  
47966

ARSAUTO	PAG.
683.NS	1
672.N	22

## **CASE-IH**

1344062C1  
3224705R2  
5126233

ARSAUTO	PAG.
672.N	22
886.N	24
779.N	22

## **FIAT**

5126233

ARSAUTO	PAG.
779.N	22

## **FENDT**

G816810150031

ARSAUTO	PAG.
941.N	22

## **JOHN DEERE**

AL78021  
AL77485  
AL77486  
ER262065

ARSAUTO	PAG.
829.N	24
666.NS	13
666.ND	13
662.N	25

## **LANDINI**

3557565M91  
3667875M91

ARSAUTO	PAG.
779.N	22
941.N	22

## **MASSEY FERGUSON**

3557565M91

ARSAUTO	PAG.
779.N	22

## **Mc CORMICK**

3557565M91

ARSAUTO	PAG.
779.N	22

## **MERLO**

0322887  
042848

ARSAUTO	PAG.
779.N	22
902.N	26

## **NEW HOLLAND**

5136505  
9975396

ARSAUTO	PAG.
779.N	22
779.N	22

## **RENAULT**

### **AGRICOLTURE**

001130811  
6005022753  
6005028116

ARSAUTO	PAG.
672.N	22
779.N	22
954.N	23

## **SAME-DEUTZ**

0.010.3563.1  
0.9233.183.3  
0433.5119  
0441.1258.1  
0443.8482

ARSAUTO	PAG.
779.N	22
779.N	22
886.N	24
941.N	22
779.N	22

## **SICAS**

PC20016101  
PC20016102  
PC20016201

ARSAUTO	PAG.
994.ND	20
932.N	23
994.NS	20



MCA S.r.l Via trieste,17 Caneva (PN) – [www.mcaricambi.it](http://www.mcaricambi.it) – [info@mcaricambi.it](mailto:info@mcaricambi.it)